

KEY MAP

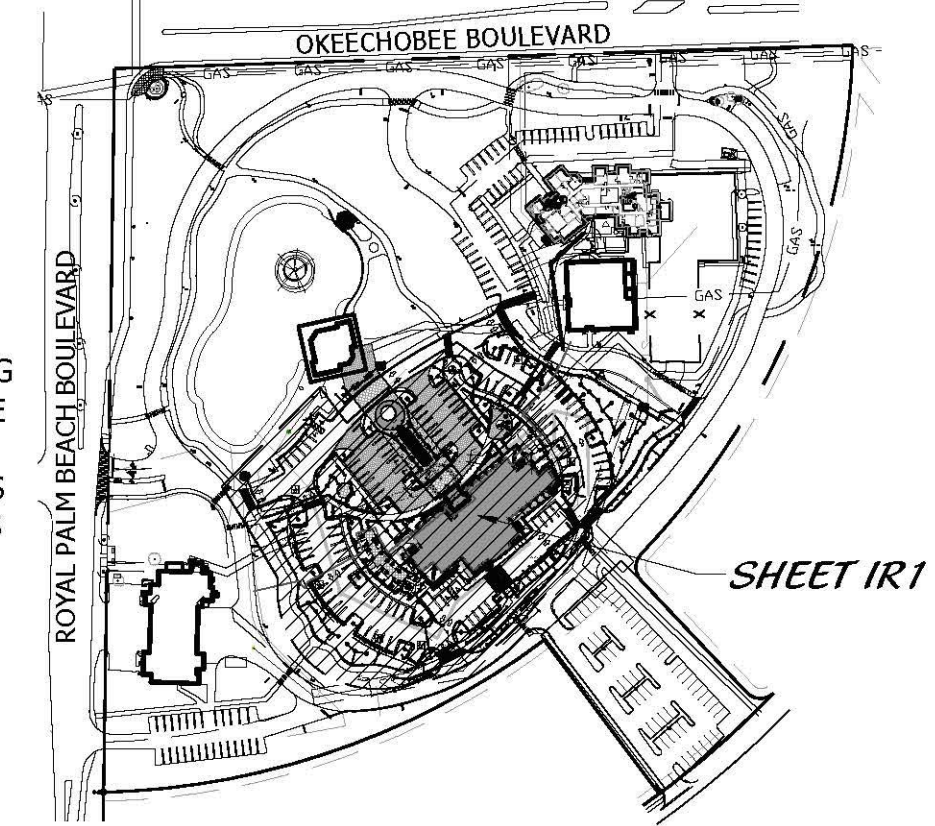

REG
Architects
Interiors
Planners
CORP# AA0002447

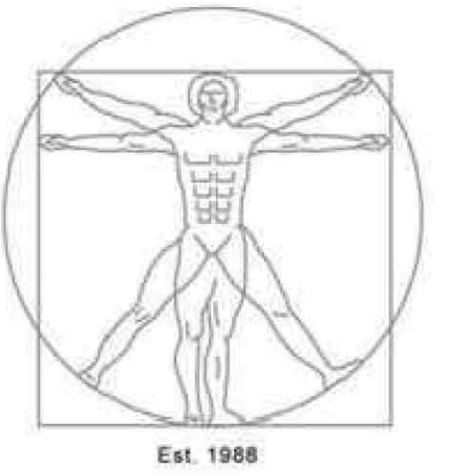

Rick Gonzalez, AIA
President
FL License AR0014172
120 South Olive Ave. Ste. 210,
West Palm Beach, FL 33401
P (561) 659-2383
www.regarchitects.com



Village Hall of
Royal Palm Beach

1050 Royal Palm Beach Blvd.
Royal Palm Beach, FL 33411

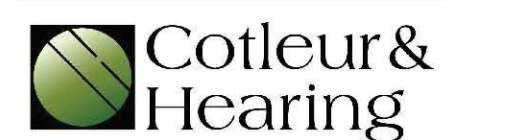

NO.	DATE	DESCRIPTION
1	5/28/21	100% CD's
	6/17/21	ADDENDA #1

DATE	05-28-2021
DESIGNER	REG/CH
DRAWN	BC/BF/RUEB
CHECKED	MHA/REG
CH#	20-0206

© REG 2020

OWNERSHIP AND USE OF THESE DOCUMENTS & SPECIFICATIONS AS INSTRUMENTS OF SERVICE ARE AND SHALL REMAIN THE PROPERTY OF THE ARCHITECT WHETHER THE PROJECT THEY ARE MADE FOR IS EXECUTED OR NOT. THEY SHALL NOT BE USED BY THE OWNER OR OTHERS ON OTHER PROJECTS OR FOR ADDITIONS TO THIS PROJECT BY OTHERS, EXCEPT BY AGREEMENT IN WRITING AND WITH APPROPRIATE COMPENSATION TO THE ARCHITECT.

Irrigation
Plan

IR-1

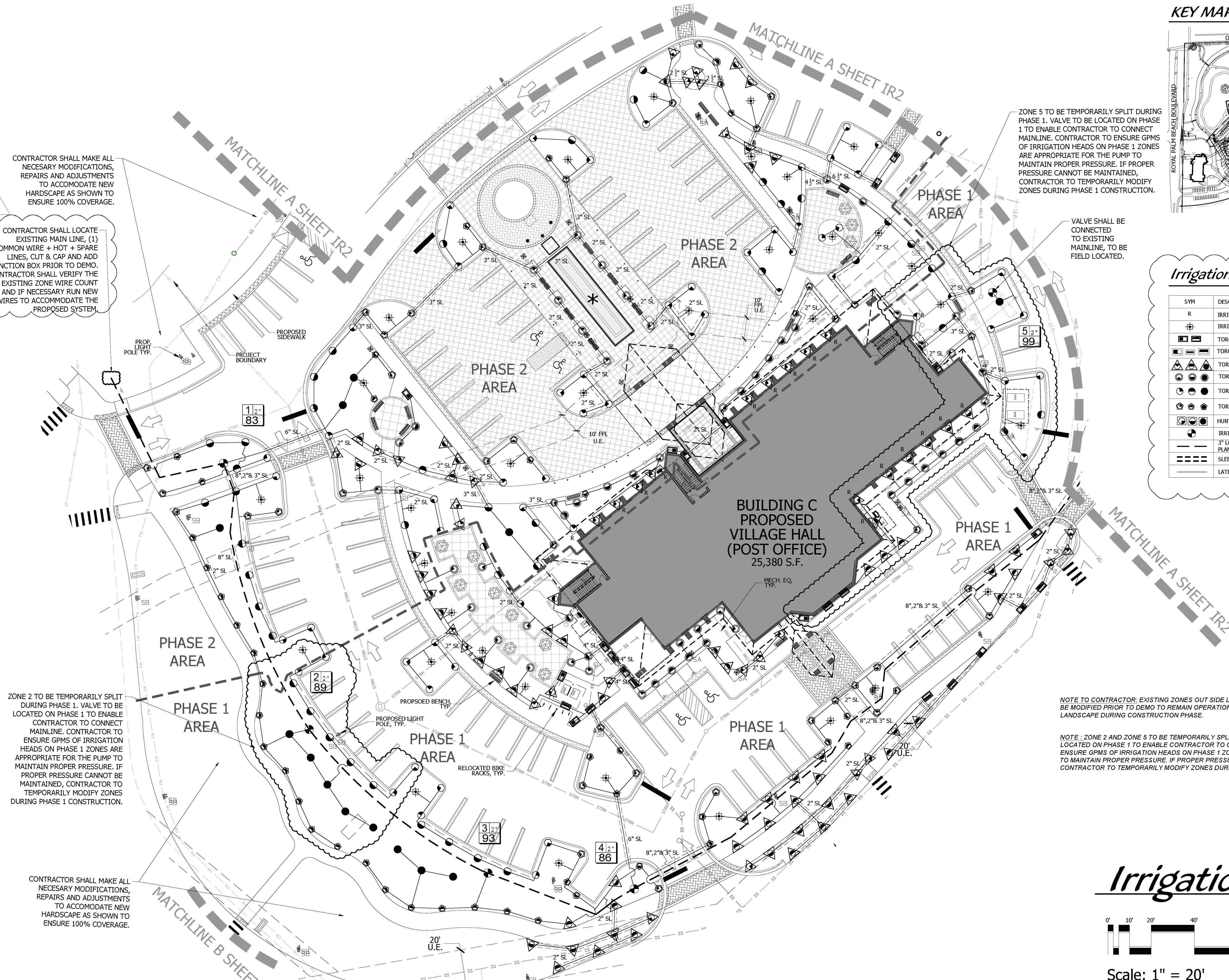

ZONE 5 TO BE TEMPORARILY SPLIT DURING PHASE 1. VALVE TO BE LOCATED ON PHASE 1 TO ENABLE CONTRACTOR TO CONNECT MAINLINE. CONTRACTOR TO ENSURE GPMS OF IRRIGATION HEADS ON PHASE 1 ZONES ARE APPROPRIATE FOR THE PUMP TO MAINTAIN PROPER PRESSURE. IF PROPER PRESSURE CANNOT BE MAINTAINED, CONTRACTOR TO TEMPORARILY MODIFY ZONES DURING PHASE 1 CONSTRUCTION.

VALVE SHALL BE CONNECTED TO EXISTING MAINLINE, TO BE FIELD LOCATED.

CONTRACTOR SHALL MAKE ALL NECESSARY MODIFICATIONS, REPAIRS AND ADJUSTMENTS TO ACCOMMODATE NEW HARDSCAPE AS SHOWN TO ENSURE 100% COVERAGE.

CONTRACTOR SHALL LOCATE EXISTING MAIN LINE, (1) COMMON WIRE + HOT + SPARE LINES, CUT & CAP AND ADD JUNCTION BOX PRIOR TO DEMO. CONTRACTOR SHALL VERIFY THE EXISTING ZONE WIRE COUNT AND IF NECESSARY RUN NEW WIRES TO ACCOMMODATE THE PROPOSED SYSTEM.

ZONE 2 TO BE TEMPORARILY SPLIT DURING PHASE 1. VALVE TO BE LOCATED ON PHASE 1 TO ENABLE CONTRACTOR TO CONNECT MAINLINE. CONTRACTOR TO ENSURE GPMS OF IRRIGATION HEADS ON PHASE 1 ZONES ARE APPROPRIATE FOR THE PUMP TO MAINTAIN PROPER PRESSURE. IF PROPER PRESSURE CANNOT BE MAINTAINED, CONTRACTOR TO TEMPORARILY MODIFY ZONES DURING PHASE 1 CONSTRUCTION.

CONTRACTOR SHALL MAKE ALL NECESSARY MODIFICATIONS, REPAIRS AND ADJUSTMENTS TO ACCOMMODATE NEW HARDSCAPE AS SHOWN TO ENSURE 100% COVERAGE.

Irrigation Legend

SYM	DESCRIPTION
R	IRRIGATION HEAD MOUNTED ON PVC RISER
⊕	IRRITROL FLOOD BUBBLER (1 GPM)
▬	TORO 570 12" POP-UP SIDE AND END STRIP
▬	TORO 570 6" POP-UP SIDE, CENTER, & END STRIP
▲	TORO 570 6" POP-UP 10' QUARTER, HALF, FULL
●	TORO 570 12" POP-UP 10' QUARTER, HALF, FULL
○	TORO 570 6" POP-UP 15' QUARTER, HALF, FULL
○	TORO 570 12" POP-UP 15' QUARTER, HALF, FULL
⊗	HUNTER PGP ADJ ROTOR 30" WITH #3 NOZZLE
⊕	IRRITROL 100 SERIES 2" ELECTRIC VALVE
---	3" LOOPED MAIN LINE, SCH 40 (AS NOTED ON PLANS)
---	SLEEVES, (SIZING AS NOTED ON PLANS)
---	LATERAL PIPE, SCH 160

NOTE TO CONTRACTOR: EXISTING ZONES OUT SIDE LIMITS OF NEW CONSTRUCTION SHALL BE MODIFIED PRIOR TO DEMO TO REMAIN OPERATIONAL AND IRRIGATE EXISTING LANDSCAPE DURING CONSTRUCTION PHASE.

NOTE : ZONE 2 AND ZONE 5 TO BE TEMPORARILY SPLIT DURING PHASE 1. VALVE TO BE LOCATED ON PHASE 1 TO ENABLE CONTRACTOR TO CONNECT MAINLINE. CONTRACTOR TO ENSURE GPMS OF IRRIGATION HEADS ON PHASE 1 ZONES ARE APPROPRIATE FOR THE PUMP TO MAINTAIN PROPER PRESSURE. IF PROPER PRESSURE CANNOT BE MAINTAINED, CONTRACTOR TO TEMPORARILY MODIFY ZONES DURING PHASE 1 CONSTRUCTION.

Irrigation Plan

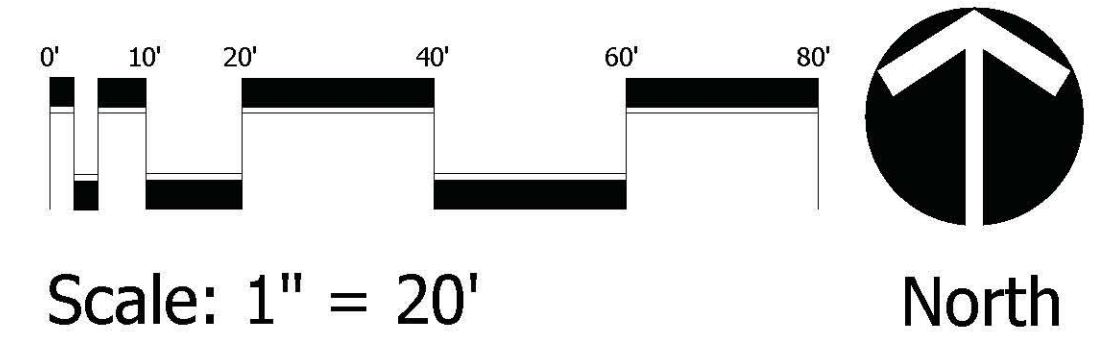

REG
Architects
Interiors
Planners
CORP# AA0002447

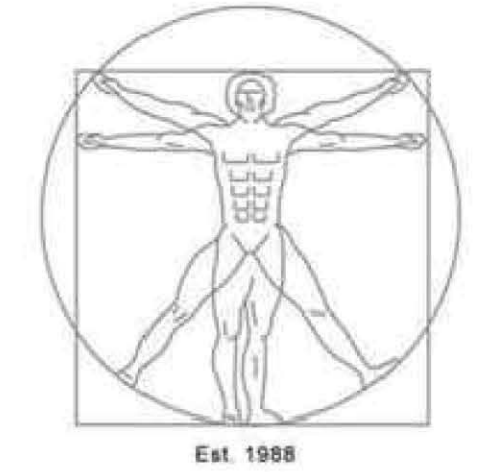

Rick Gonzalez, AIA
President
FL License AR0014172
120 South Olive Ave. Ste. 210,
West Palm Beach, FL 33401
P (561) 659-2383
www.regarchitects.com



Village Hall of
Royal Palm Beach

1050 Royal Palm Beach Blvd.
Royal Palm Beach, FL 33411



NO.	DATE	DESCRIPTION
1	5/28/21	100% CD's
	6/17/21	ADDENDA #1

DATE	05-28-2021
DESIGNER	REG/CH
DRAWN	BC/BF/RL/EB
CHECKED	MHA/REG
CH #	20-0206

© REG 2020

OWNERSHIP AND USE OF THESE DOCUMENTS & SPECIFICATIONS AS INSTRUMENTS OF SERVICE ARE AND SHALL REMAIN THE PROPERTY OF THE ARCHITECT WHETHER THE PROJECT THEY ARE MADE FOR IS EXECUTED OR NOT. THEY SHALL NOT BE USED BY THE OWNER OR OTHERS ON OTHER PROJECTS OR FOR ADDITIONS TO THIS PROJECT BY OTHERS, EXCEPT BY AGREEMENT IN WRITING AND WITH APPROPRIATE COMPENSATION TO THE ARCHITECT.

Irrigation
Plans

IR-2

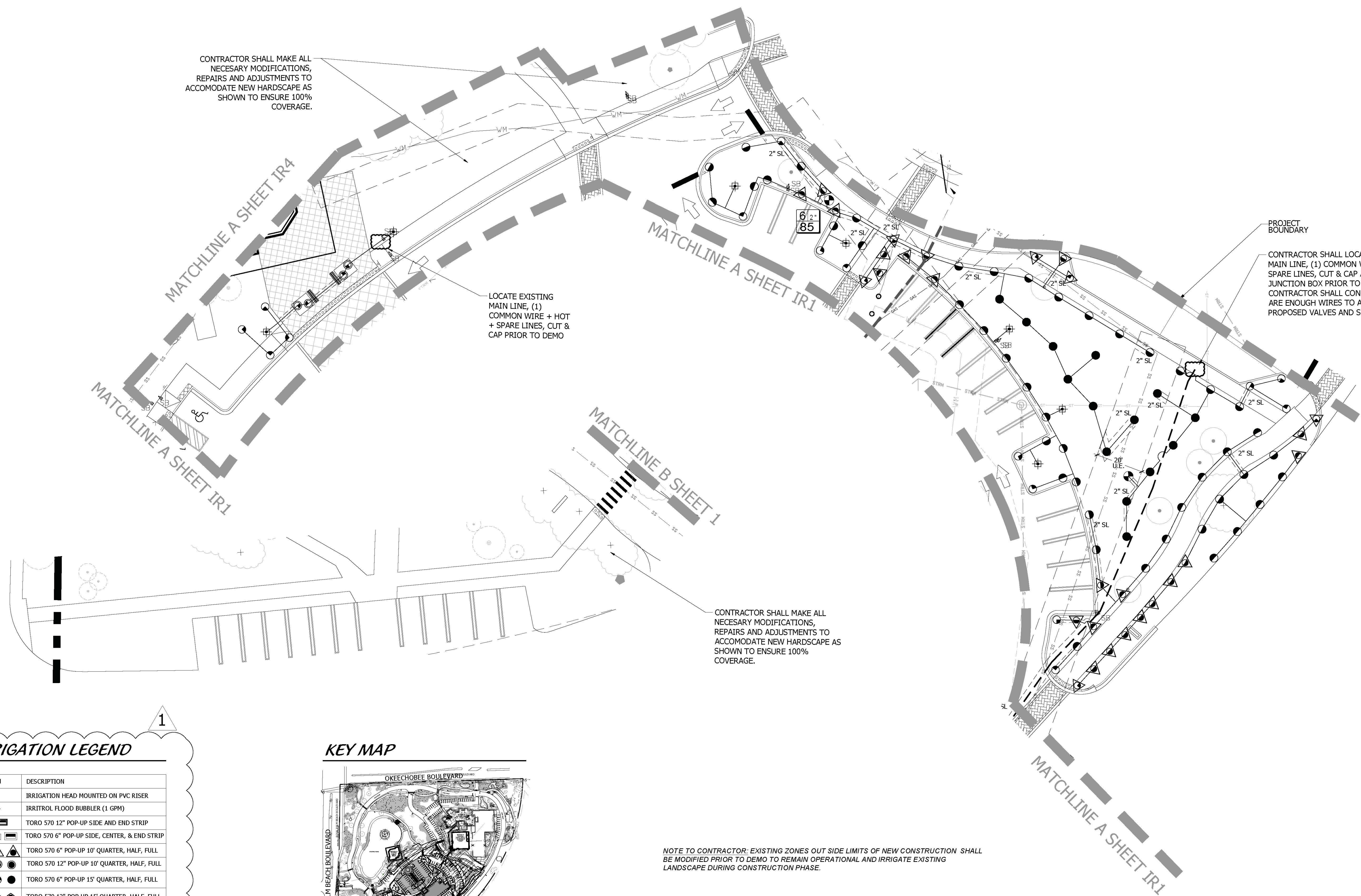

CONTRACTOR SHALL MAKE ALL NECESSARY MODIFICATIONS, REPAIRS AND ADJUSTMENTS TO ACCOMMODATE NEW HARDSCAPE AS SHOWN TO ENSURE 100% COVERAGE.

LOCATE EXISTING MAIN LINE, (1) COMMON WIRE + HOT + SPARE LINES, CUT & CAP PRIOR TO DEMO

CONTRACTOR SHALL LOCATE EXISTING MAIN LINE, (1) COMMON WIRE + HOT + SPARE LINES, CUT & CAP AND ADD JUNCTION BOX PRIOR TO DEMO. CONTRACTOR SHALL CONFIRM THERE ARE ENOUGH WIRES TO ACCOMMODATE PROPOSED VALVES AND SPARE WIRES.

CONTRACTOR SHALL MAKE ALL NECESSARY MODIFICATIONS, REPAIRS AND ADJUSTMENTS TO ACCOMMODATE NEW HARDSCAPE AS SHOWN TO ENSURE 100% COVERAGE.

NOTE TO CONTRACTOR: EXISTING ZONES OUT SIDE LIMITS OF NEW CONSTRUCTION SHALL BE MODIFIED PRIOR TO DEMO TO REMAIN OPERATIONAL AND IRRIGATE EXISTING LANDSCAPE DURING CONSTRUCTION PHASE.

IRRIGATION LEGEND

SYM	DESCRIPTION
R	IRRIGATION HEAD MOUNTED ON PVC RISER
⊕	IRRITROL FLOOD BUBBLER (1 GPM)
▬	TORO 570 12" POP-UP SIDE AND END STRIP
▬	TORO 570 6" POP-UP SIDE, CENTER, & END STRIP
⊙	TORO 570 6" POP-UP 10' QUARTER, HALF, FULL
⊙	TORO 570 12" POP-UP 10' QUARTER, HALF, FULL
⊙	TORO 570 6" POP-UP 15' QUARTER, HALF, FULL
⊙	TORO 570 12" POP-UP 15' QUARTER, HALF, FULL
⊙	HUNTER PGP ADJ ROTOR 30" WITH #3 NOZZLE
⊕	IRRITROL 100 SERIES 2" ELECTRIC VALVE
—	3" LOOPED MAIN LINE, SCH 40 (AS NOTED ON PLANS)
—	SLEEVES, (SIZING AS NOTED ON PLANS)
—	LATERAL PIPE, SCH 160

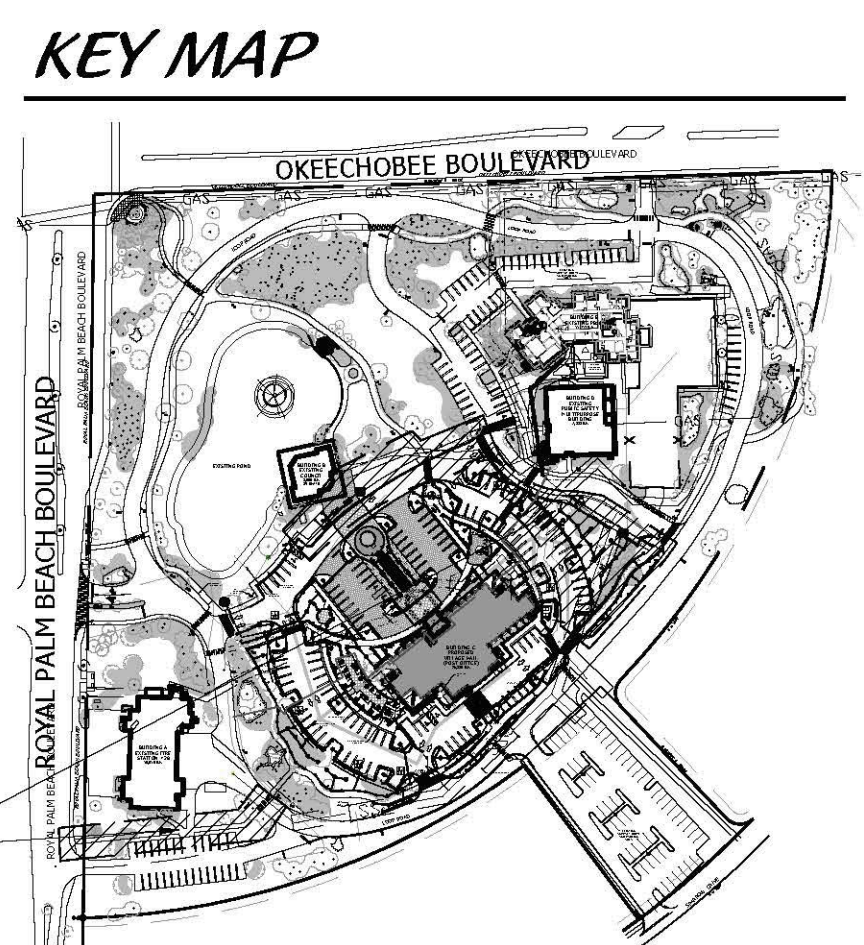

Irrigation Plan

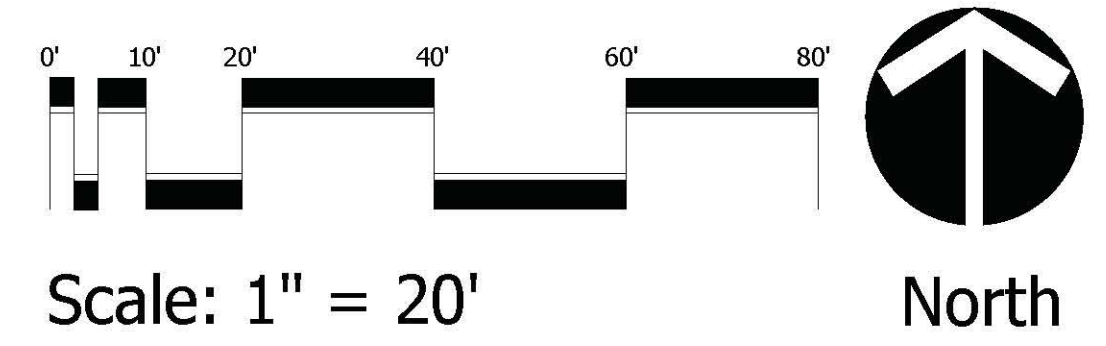

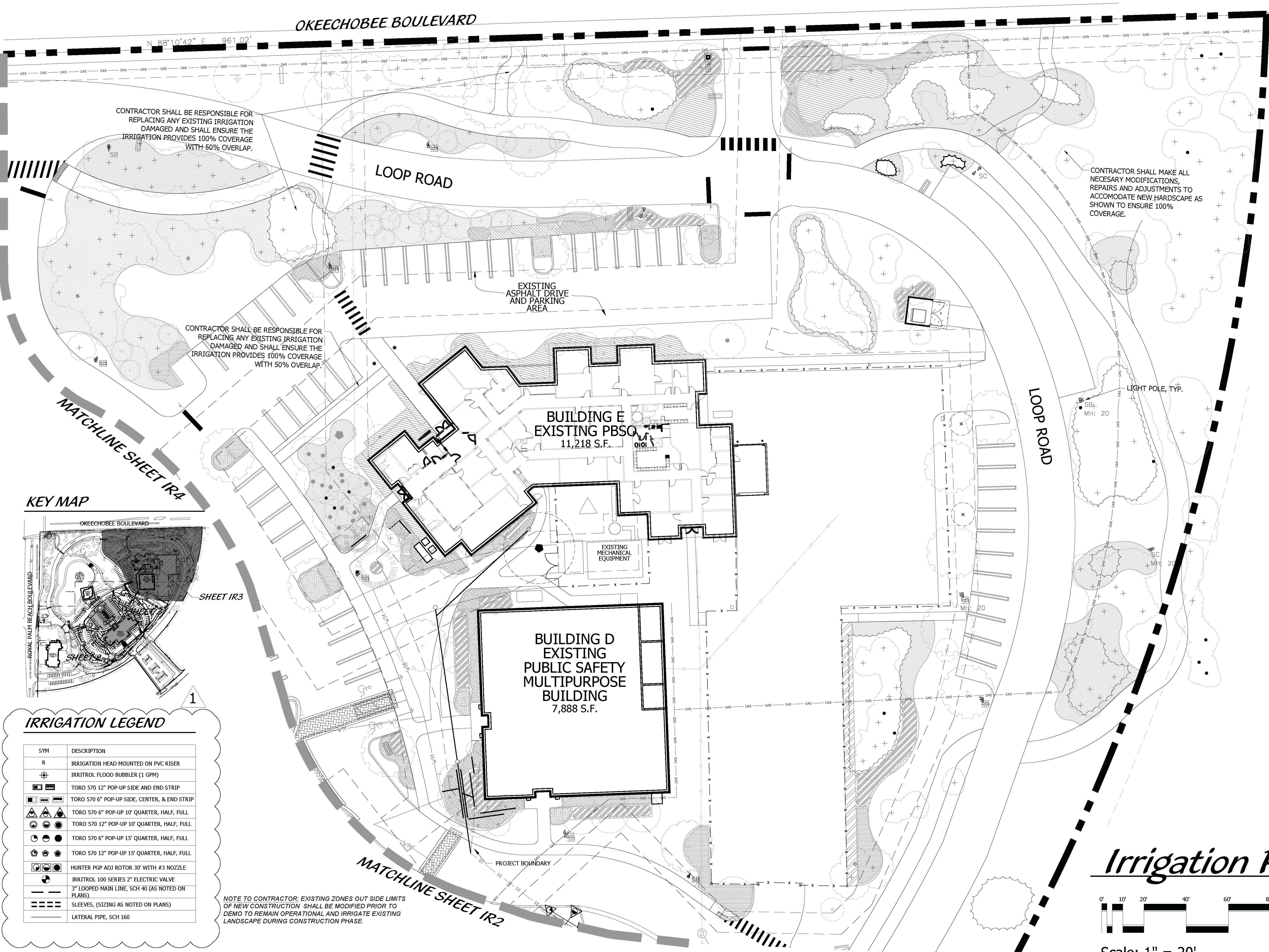

REG
Architects
Interiors
Planners
CORP# AA0002447

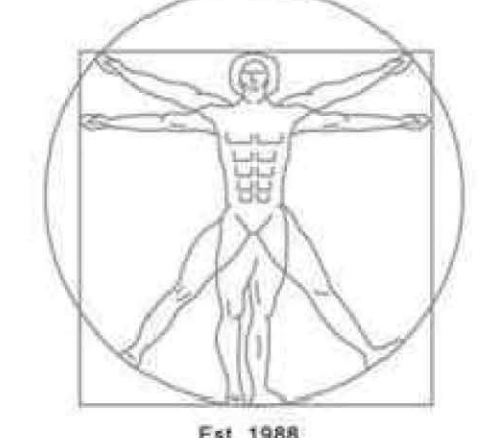

Rick Gonzalez, AIA
President
FL License AR0014172
120 South Olive Ave. Ste. 210,
West Palm Beach, FL 33401
P (561) 659-2383
www.regarchitects.com



**Village Hall of
Royal Palm Beach**

1050 Royal Palm Beach Blvd.
Royal Palm Beach, FL 33411

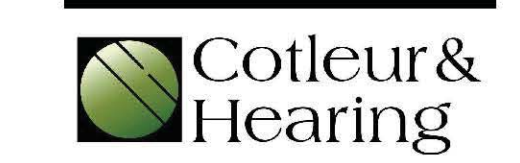

NO.	DATE	DESCRIPTION
	5/28/21	100% CD's
1	6/17/21	ADDENDA #1

DATE	05-28-2021
DESIGNER	REG/CH
DRAWN	BC/BF/RL/EB
CHECKED	MHA/REG
CH #	20-0206

© REG 2020

OWNERSHIP AND USE OF THESE DOCUMENTS & SPECIFICATIONS AS INSTRUMENTS OF SERVICE ARE AND SHALL REMAIN THE PROPERTY OF THE ARCHITECT WHETHER THE PROJECT THEY ARE MADE FOR IS EXECUTED OR NOT. THEY SHALL NOT BE USED BY THE OWNER OR OTHERS ON OTHER PROJECTS OR FOR ADDITIONS TO THIS PROJECT BY OTHERS, EXCEPT BY AGREEMENT IN WRITING AND WITH APPROPRIATE COMPENSATION TO THE ARCHITECT.

Irrigation
Plans

IR-3

Irrigation Plan

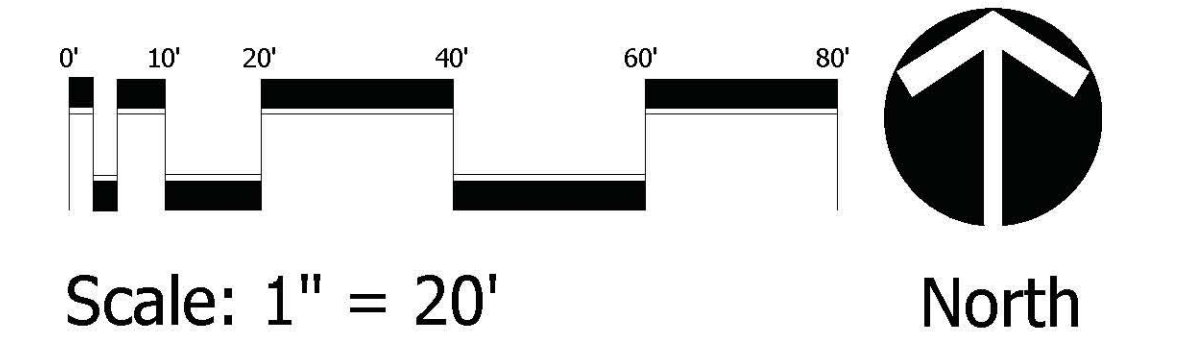

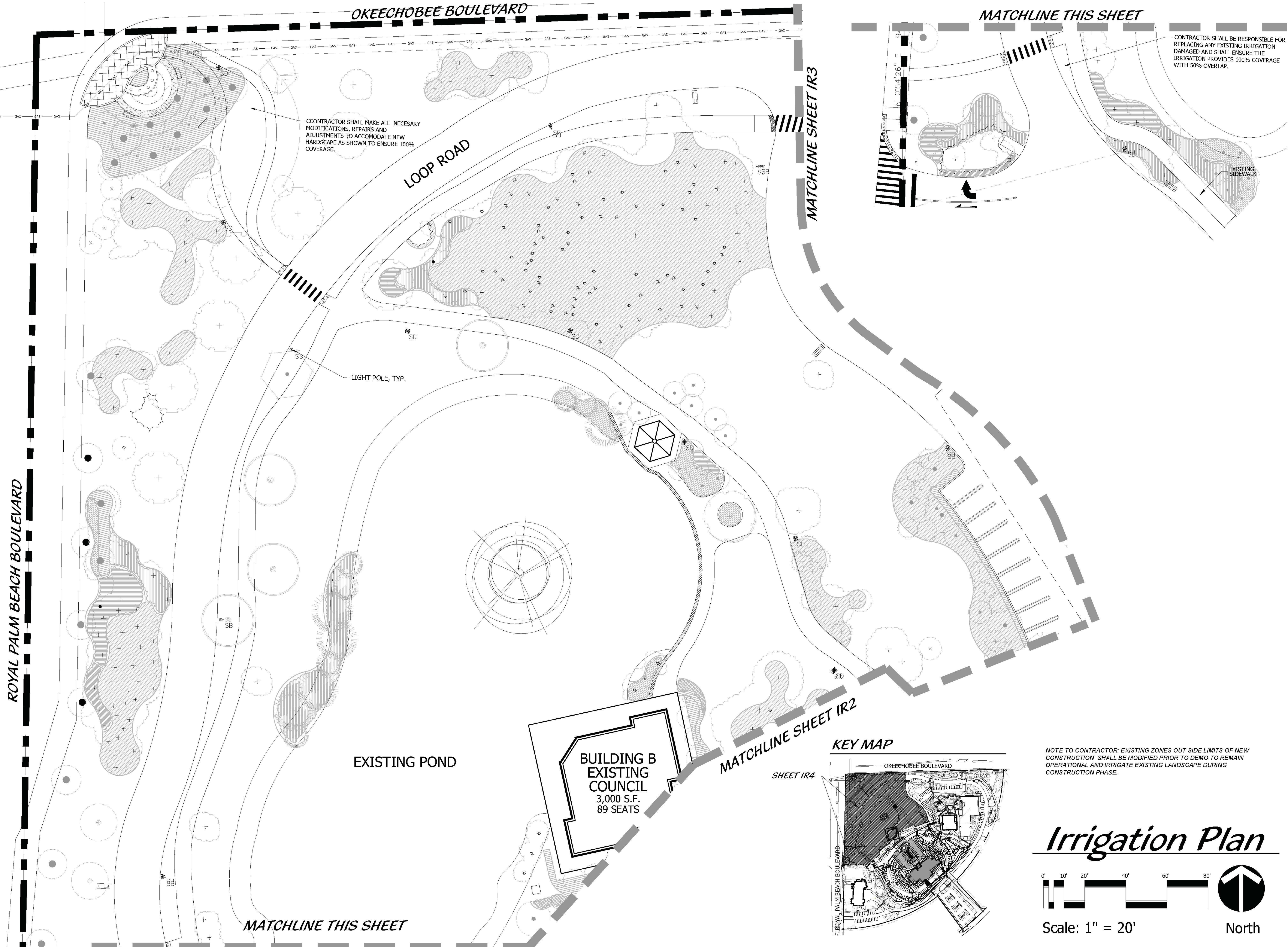

REG
Architects
Interiors
Planners
CORP# AA0002447

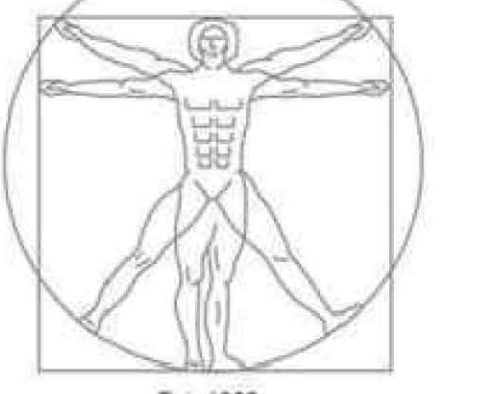

Est. 1988
Rick Gonzalez, AIA
President
FL License AR0014172
120 South Olive Ave. Ste. 210,
West Palm Beach, FL 33401
P (561) 659-2383
www.regarchitects.com



Village Hall of
Royal Palm Beach

1050 Royal Palm Beach Blvd.
Royal Palm Beach, FL 33411



NO.	DATE	DESCRIPTION
	5/28/21	100% CD's.
▲	6/17/21	ADDENDA#1

DATE	05-28-2021
DESIGNER	REG/CH
DRAWN	BC/BF/RL/EB
CHECKED	MHA/REG
CH #	20-0206

© REG 2020

OWNERSHIP AND USE OF THESE DOCUMENTS & SPECIFICATIONS AS INSTRUMENTS OF SERVICE ARE AND SHALL REMAIN THE PROPERTY OF THE ARCHITECT WHETHER THE PROJECT THEY ARE MADE FOR IS EXECUTED OR NOT. THEY SHALL NOT BE USED BY THE OWNER OR OTHERS ON OTHER PROJECTS OR FOR ADDITIONS TO THIS PROJECT BY OTHERS, EXCEPT BY AGREEMENT IN WRITING AND WITH APPROPRIATE COMPENSATION TO THE ARCHITECT.

Irrigation
Plans

IR-4

IRRIGATION NOTES & SPECIFICATIONS

A. EXTENT:

INCLUDES FURNISHING ALL LABOR, MATERIALS AND EQUIPMENT FOR THE PROPER INSTALLATION OF THE IRRIGATION SYSTEM. THE WORK INCLUDES, BUT IS NOT LIMITED TO THE FOLLOWING: (1) TRENCHING AND BACKFILL; (2) AUTOMATICALLY CONTROLLED IRRIGATION SYSTEM; (3) TEST ALL SYSTEMS AND MAKE OPERATIVE; (4) "AS-BUILT" DRAWINGS.

B. GENERAL:

- PERMITS AND FEES: OBTAIN ALL PERMITS AND PAY REQUIRED FEES TO ANY GOVERNMENT AGENCY HAVING JURISDICTION OVER THE WORK. INSPECTIONS REQUIRED BY LOCAL ORDINANCES DURING THE COURSE OF CONSTRUCTION SHALL BE ARRANGED AS REQUIRED. ON COMPLETION OF WORK, SATISFACTORY EVIDENCE SHALL BE FURNISHED TO THE TENANT'S CONSTRUCTION REPRESENTATIVE TO SHOW THAT ALL WORK HAS BEEN INSTALLED IN ACCORDANCE WITH THE ORDINANCES AND CODE REQUIREMENTS.
- APPROVAL: WHEREVER THE TERMS "APPROVE" OR "APPROVED" ARE USED IN THE SPECIFICATIONS, THEY SHALL MEAN THE APPROVAL OF THE TENANT'S CONSTRUCTION REPRESENTATIVE IN WRITING.
- BEFORE ANY WORK IS STARTED, A CONFERENCE SHALL BE HELD BETWEEN THE CONTRACTOR AND THE TENANT'S CONSTRUCTION REPRESENTATIVE CONCERNING THE WORK UNDER THIS CONTRACT.
- COORDINATION: COORDINATE AND COOPERATE WITH OTHER CONTRACTORS TO ENABLE THE WORK TO PROCEED AS RAPIDLY AND EFFICIENTLY AS POSSIBLE.
- INSPECTION OF SITE:

- CONTRACTOR SHALL ACQUAINT HIMSELF WITH ALL SITE CONDITIONS. SUBMISSION OF HIS PROPOSAL SHALL BE CONSIDERED EVIDENCE THAT THE EXAMINATION HAS BEEN CONDUCTED. SHOULD UTILITIES NOT SHOWN ON THE PLANS BE FOUND DURING EXCAVATIONS, CONTRACTOR SHALL PROMPTLY NOTIFY THE TENANT'S CONSTRUCTION REPRESENTATIVE FOR INSTRUCTIONS AS TO FURTHER ACTION. FAILURE TO DO SO WILL MAKE CONTRACTOR LIABLE FOR ANY AND ALL DAMAGE THERETO ARISING FROM HIS OPERATIONS SUBSEQUENT TO SUCH UTILITIES NOT SHOWN IN PLANS.
- CONTRACTOR SHALL MAKE NECESSARY ADJUSTMENTS IN THE LAYOUT AS MAY BE REQUIRED TO CONNECT TO EXISTING STUBOUTS, SHOULD SUCH STUBS NOT BE LOCATED EXACTLY AS SHOWN, AND AS MAY BE REQUIRED TO WORK AROUND EXISTING WORK AT NO INCREASE IN COST TO THE TENANT'S CONSTRUCTION REPRESENTATIVE.

- PROTECTION OF EXISTING PLANTS AND SITE CONDITIONS: THE CONTRACTOR SHALL TAKE NECESSARY PRECAUTIONS TO PROTECT SITE CONDITIONS TO REMAIN. SHOULD DAMAGE BE INCURRED, THIS CONTRACTOR SHALL REPAIR THE DAMAGE TO ITS ORIGINAL CONDITION AT HIS OWN EXPENSE.

- THE OWNER RESERVES THE RIGHT TO SUBSTITUTE, ADD, OR DELETE ANY MATERIAL OR WORK AS THE WORK PROGRESSES. ADJUSTMENTS TO THE CONTRACT PRICE SHALL BE NEGOTIATED IF DEEMED NECESSARY BY THE OWNER ON A PER DIEM BASIS.

- THE OWNER RESERVES THE RIGHT TO REJECT MATERIAL OR WORK WHICH DOES NOT CONFORM TO THE CONTRACT DOCUMENTS. REJECTED WORK SHALL BE REMOVED OR CORRECTED AT THE EARLIEST TIME POSSIBLE.

- WORK SCHEDULE: WITHIN 10 DAYS AFTER AWARD OF THE CONTRACT, THE CONTRACTOR SHALL SUBMIT TO THE OWNER A WORK SCHEDULE.

- "AS-BUILT" IRRIGATION DRAWINGS: PREPARE AN "AS-BUILT" DRAWING ON A BLUEPRINT WHICH SHALL SHOW DEVIATIONS FROM THE BID DOCUMENTS MADE DURING CONSTRUCTION AFFECTING THE MAIN LINE PIPE, CONTROLLER LOCATIONS, SLEEVES, REMOTE CONTROL VALVES AND QUICK COUPLING VALVES. THE DRAWINGS SHALL ALSO INDICATE AND SHOW APPROVED SUBSTITUTIONS OF SIZE, MATERIAL AND MANUFACTURER'S NAME AND CATALOG NAME AND CATALOG NUMBER. THE DRAWINGS SHALL BE DELIVERED TO THE TENANT'S CONSTRUCTION REPRESENTATIVE BEFORE FINAL ACCEPTANCE OF WORK.

- FINAL ACCEPTANCE: FINAL ACCEPTANCE OF THE WORK MAY BE OBTAINED FROM THE TENANT'S CONSTRUCTION REPRESENTATIVE UPON THE SATISFACTORY COMPLETION OF ALL WORK.

- GUARANTEE: ALL WORK SHALL BE GUARANTEED FOR ONE YEAR FROM DATE OF ACCEPTANCE AGAINST ALL DEFECTS IN MATERIAL, EQUIPMENT AND WORKMANSHIP. GUARANTEE SHALL ALSO COVER REPAIR OF DAMAGE TO ANY PART OF THE PREMISES RESULTING FROM LEAKS OR OTHER DEFECTS IN MATERIAL, EQUIPMENT AND WORKMANSHIP TO THE SATISFACTORY OF THE TENANT'S CONSTRUCTION REPRESENTATIVE. REPAIRS, IF REQUIRED, SHALL BE DONE PROMPTLY AT NO COST TO THE OWNER.

C. MATERIALS:

- GENERAL: ALL MATERIALS THROUGHOUT THE SYSTEM SHALL BE NEW AND IN PERFECT CONDITION.
- PLASTIC PIPING: ALL MAIN LINES SHALL BE SCH. 40 TYPE 1120-1220 POLYVINYL CHLORIDE (PVC) PIPE AND SHALL CONFORM TO CS-256-63. ALL LATERAL PIPING SHALL BE PVC CLASS SCH 40 SOLVENT WELD CONFORMING TO ASTM D-1784 AND D-2241.
- PLASTIC FITTINGS: SCH. 40 SOLVENT WELD, POLYVINYL CHLORIDE (PVC) STANDARD WEIGHT AS MANUFACTURED BY SLOANE, LASCO, OR APPROVED EQUAL.
- SOLVENT CEMENT: COMPATIBLE WITH PVC PIPE, OF PROPER CONSISTENCY, AND COLOR.

- SPRINKLER HEAD RISERS: SCH. 40 PVC FOR RISERS. PIPE SHALL BE CUT IN A STANDARD PIPE CUTTING TOOL WITH SHARP CUTTERS. REAM ONLY TO FULL DIAMETER OF PIPE AND CLEAN ALL ROUGH EDGES OR BURRS. CUT ALL THREADS ACCURATELY WITH SHARP DIES. NOT MORE THAN THREE (3) FULL THREADS SHALL SHOW BEYOND FITTINGS WHEN PIPE IS MADE UP. ASSEMBLIES SHALL BE AS DETAILED.

- AUTOMATIC CONTROLLERS: SEE LEGEND
- REMOTE CONTROL VALVES: SEE LEGEND

- CONTROL WIRING: 24 VOLT SOLID U/L APPROVED FOR DIRECT BURIAL IN GROUND. MINIMUM WIRE SIZE: 14 GAUGE FOR HOT LEAD AND 12 GAUGE FOR COMMON LEAD.

- SLEEVES FOR CONTROL WIRING: UNDER ALL WALKS AND PAVED AREAS AND WHERE INDICATED ON DRAWINGS. MINIMUM PVC SCH. 40 PSI PLASTIC PIPE.

- SPRINKLER HEADS: SEE LEGEND
- QUICK COUPLING VALVES: SHALL BE NOTED ON DRAWINGS.

D. WORKMANSHIP:

- LAY OUT WORK AS ACCURATELY AS POSSIBLE TO THE DRAWINGS. THE DRAWINGS SHOULD CAREFULLY DRAWN, ARE GENERALLY DIAGRAMMATIC TO THE EXTENT THAT SWING JOINTS, OFFSETS, AND ALL FITTINGS ARE NOT SHOWN.
- THE CONTRACTOR SHALL BE RESPONSIBLE FOR FULL AND COMPLETE COVERAGE OF ALL IRRIGATED AREAS AND SHALL MAKE ANY NECESSARY MINOR ADJUSTMENTS AT NO ADDITIONAL COSTS TO THE TENANT'S CONSTRUCTION REPRESENTATIVE.
- ANY MAJOR REVISIONS TO THE IRRIGATION SYSTEM MUST BE SUBMITTED AND ANSWERED IN WRITTEN FORM, ALONG WITH ANY CHANGE IN CONTRACT PRICE.

E. INSTALLATION:

- EXCAVATION AND TRENCHING:
 - PERFORM ALL EXCAVATIONS AS REQUIRED FOR THE INSTALLATION OF THE WORK INCLUDING UNDER THIS SECTION, INCLUDING SHORING OF EARTH BANKS TO PREVENT CAVE-INS. RESTORE ALL SURFACES, EXISTING UNDERGROUND INSTALLATIONS, ETC., DAMAGED OR CUT AS A RESULT OF THE EXCAVATIONS TO THEIR ORIGINAL CONDITION AND IN A MANNER APPROVED BY THE OWNER.
 - TRENCHES SHALL BE MADE WIDE ENOUGH TO ALLOW A MINIMUM OF 6 INCHES BETWEEN PARALLEL PIPE LINES. TRENCHES FOR PIPE LINES SHALL BE MADE OF SUFFICIENT DEPTHS TO PROVIDE THE MINIMUM COVER FROM FINISH GRADE AS FOLLOWS:
 - 18" MINIMUM COVER OVER MAIN LINES
 - 18" MINIMUM COVER OVER CONTROL WIRING FROM CONTROLLER TO VALVES.
 - 12" MINIMUM COVER OVER LATERAL LINES TO HEADS
 - UNDER ROADWAY, 36" MINIMUM COVER OVER ALL LATERALS, SLEEVES AND MAINLINES.
 - MAINTAIN ALL WARNING SIGNS, SHORING, BARRICADES, FLARES AND RED LANTERNS AS REQUIRED BY THE SAFETY ORDERS OF THE DIVISION OF INDUSTRIAL SAFETY AND LOCAL ORDINANCES.
- PIPE LINE ASSEMBLY:

- INSTALL REMOTE CONTROL VALVES WHERE SHOWN AND GROUP TOGETHER WHERE PRACTICAL. PLACE NO CLOSER THAN 24 INCHES TO WALK EDGES, BUILDINGS AND WALLS.
- PLASTIC PIPE AND FITTINGS SHALL BE SOLVENT WELDED USING SOLVENTS AND METHODS RECOMMENDED BY MANUFACTURER OF THE PIPE, EXCEPT WHERE SCREWED CONNECTIONS ARE REQUIRED. PIPE AND FITTINGS SHALL BE THOROUGHLY CLEANED OF DIRT, DUST AND MOISTURE BEFORE APPLYING SOLVENT WITH A NON-SYNTHETIC BRISTLE BRUSH.
- PIPE MAY BE ASSEMBLED AND WELDED ON THE SURFACE. SNAKE PIPE FROM SIDE TO SIDE TO TRENCH BOTTOM TO ALLOW FOR EXPANSION AND CONTRACTION.
- MAKE ALL CONNECTIONS BETWEEN PLASTIC PIPE AND METAL VALVES OR STEEL PIPE WITH THREADED FITTINGS USING PLASTIC MALE ADAPTERS.

- SPRINKLER HEADS:
 - INSTALL ALL SPRINKLERS AS DETAILED ON DRAWINGS.
 - DO NOT SCALE PLANS FOR EXACT HEAD LOCATION.

- CLOSING OF PIPE AND FLUSHING LINES:
 - CAP OR PLUG ALL OPENINGS AS SOON AS LINES HAVE BEEN INSTALLED TO PREVENT THE ENTRANCE OF MATERIALS THAT WOULD OBSTRUCT THE PIPE. LEAVE IN PLACE UNTIL REMOVAL IS NECESSARY FOR COMPLETION OF INSTALLATION
 - THOROUGHLY FLUSH OUT ALL WATER LINES BEFORE INSTALLING HEADS, VALVES AND OTHER HYDRANTS.
 - TEST IN ACCORDANCE WITH PARAGRAPH ON HYDROSTATIC TESTS.
 - UPON COMPLETION OF THE TESTING, THE CONTRACTOR SHALL COMPLETE ASSEMBLY AND ADJUST SPRINKLER HEADS FOR PROPER DISTRIBUTION.

- HYDROSTATIC TESTS:
 - REQUEST THE PRESENCE OF THE OWNER IN WRITING AT LEAST 48 HOURS IN ADVANCE OF TESTING.
 - TESTING TO BE ACCOMPLISHED AT THE EXPENSE OF THE CONTRACTOR AND IN THE PRESENCE OF THE OWNER.
 - CENTER LOAD PIPING WITH SMALL AMOUNT OF BACKFILL TO PREVENT ARCHING OR SLIPPING UNDER PRESSURE.
 - APPLYING A CONTINUOUS AND STATIC WATER PRESSURE OF 100 PSI WHEN WELDED PLASTIC JOINTS HAVE CURED AT LEAST 2 HOURS AND WITH THE RISERS CAPPED AS FOLLOWS:
 - MAIN LINES AND SUBMAINS TO BE TESTED FOR 2 HOURS WITH A MINIMUM 8 PSI LOSS.
 - REPAIR LEAKS RESULTING FROM TESTS.

- AUTOMATIC CONTROLLERS:
 - CONNECT REMOTE CONTROL VALVES TO CONTROLLER IN A CLOCKWISE SEQUENCE TO CORRESPOND WITH STATION SETTING BEGINNING WITH STATIONS 1, 2, 3, ETC.

- AUTOMATIC CONTROL WIRING:
 - INSTALL CONTROL WIRING, SPRINKLER MAINS AND LATERALS IN COMMON TRENCHES WHEREVER POSSIBLE.
 - INSTALL CONTROL WIRES AT LEAST 18" BELOW FINISH GRADE AND LAY TO THE SIDE AND BELOW THE MAIN LINE. PROVIDE LOOPED SLACK AT VALVES AND SNAKE WIRES IN TRENCH TO ALLOW FOR CONTRACTION OF WIRES. THE WIRES IN BUNDLES AT INTERVALS.
 - CONTROL WIRE SPLICES WILL BE ALLOWED IN 12"x18" VALVE BOX ONLY RUNS OVER 500 FT. CONNECTIONS SHALL LOCATED ON AS-BUILT PLAN.
 - ALL WIRING PASSING UNDER EXISTING OR FUTURE PAVING, CONSTRUCTION, ETC., SHALL BE ENCASED IN PLASTIC OR GALVANIZED STEEL CONDUIT EXTENDING AT LEAST 12" BEYOND EDGES OF PAVING OR CONSTRUCTION.
 - IF WIRING IS INSTALLED IN THE SAME SLEEVE AS A MAIN OR ZONE LINE, THE WIRING SHALL BE ENCASED IN A SEPARATE CONDUIT FOR THE ENTIRE LENGTH OF THE SLEEVE.

- BACKFILL AND COMPACTING:
 - AFTER SYSTEM IS OPERATING AND REQUIRED TESTS AND INSPECTIONS HAVE BEEN MADE, BACKFILL EXCAVATIONS AND TRENCHES WITH CLEAN SOIL, FREE OF RUBBISH.
 - BACKFILL FOR ALL TRENCHES, REGARDLESS OF THE TYPE OF PIPE COVERED, SHALL BE COMPACTED TO MINIMUM 95% DENSITY.
 - COMPACT TRENCHES IN AREAS TO BE PLANTED BY THOROUGHLY FLOODING THE BACKFILL. JETTING PROCESS MAY BE USED IN THOSE AREAS.
 - DRESS OFF ALL AREAS TO FINISH GRADES.

- CLEAN-UP: REMOVE FROM THE SITE ALL DEBRIS RESULTING FROM WORK OF THIS SECTION.

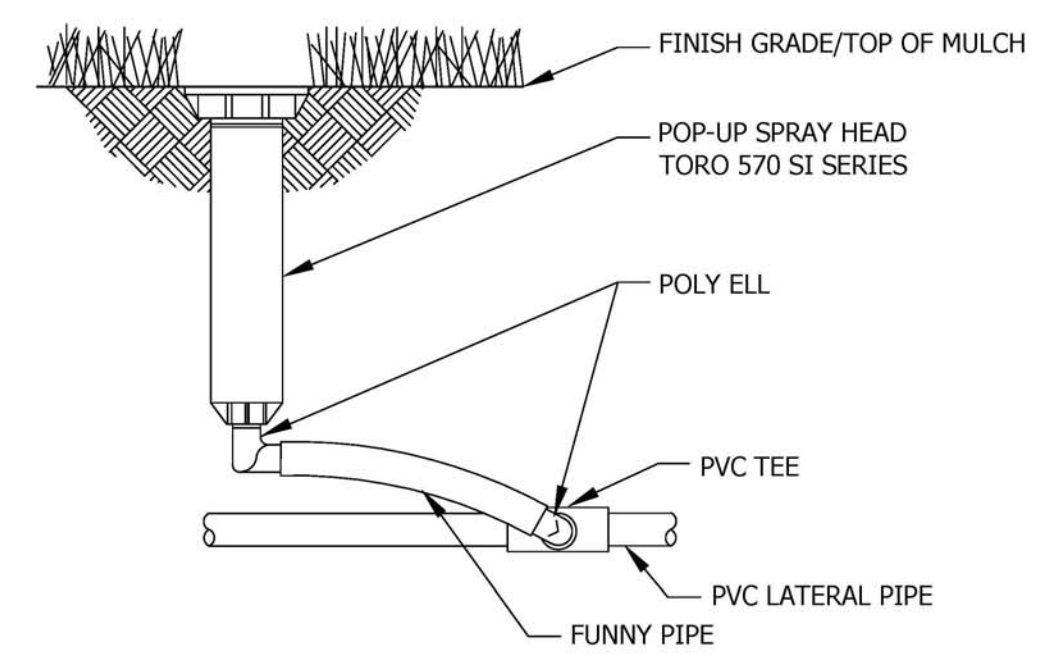

TORO 570 6" OR 12" POP-UP MIST HEAD DETAIL N.T.S.

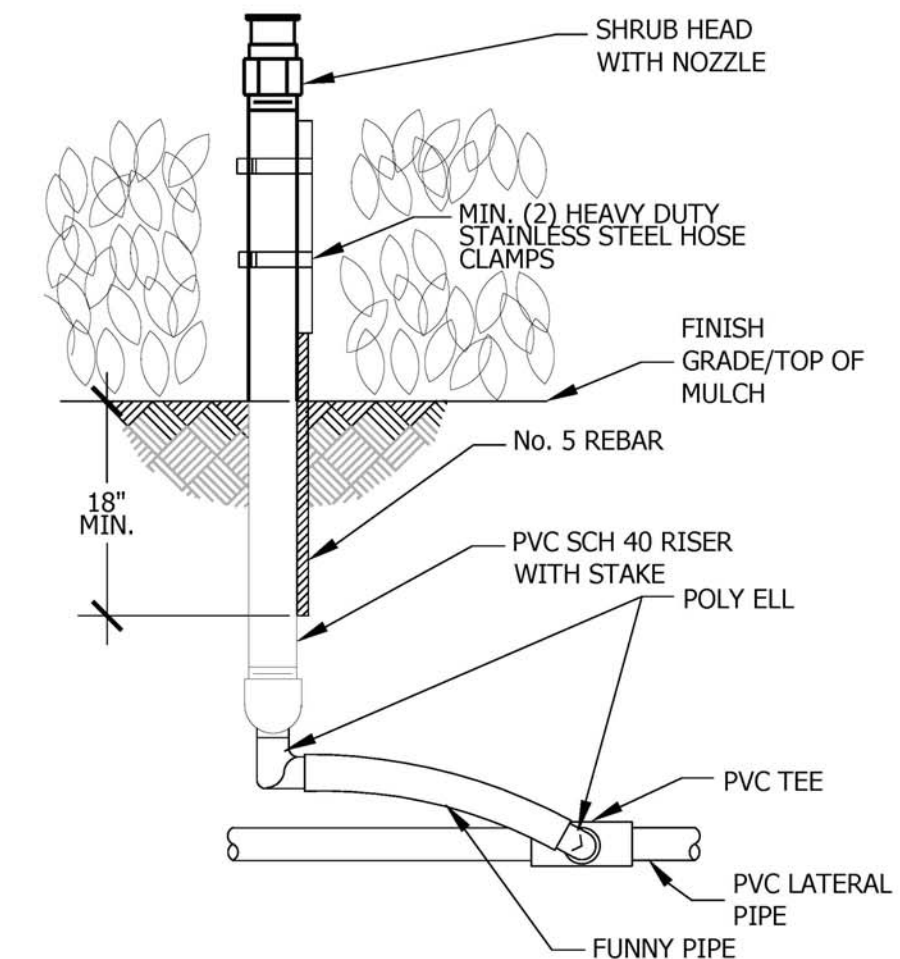

SHRUB RISER DETAIL N.T.S.

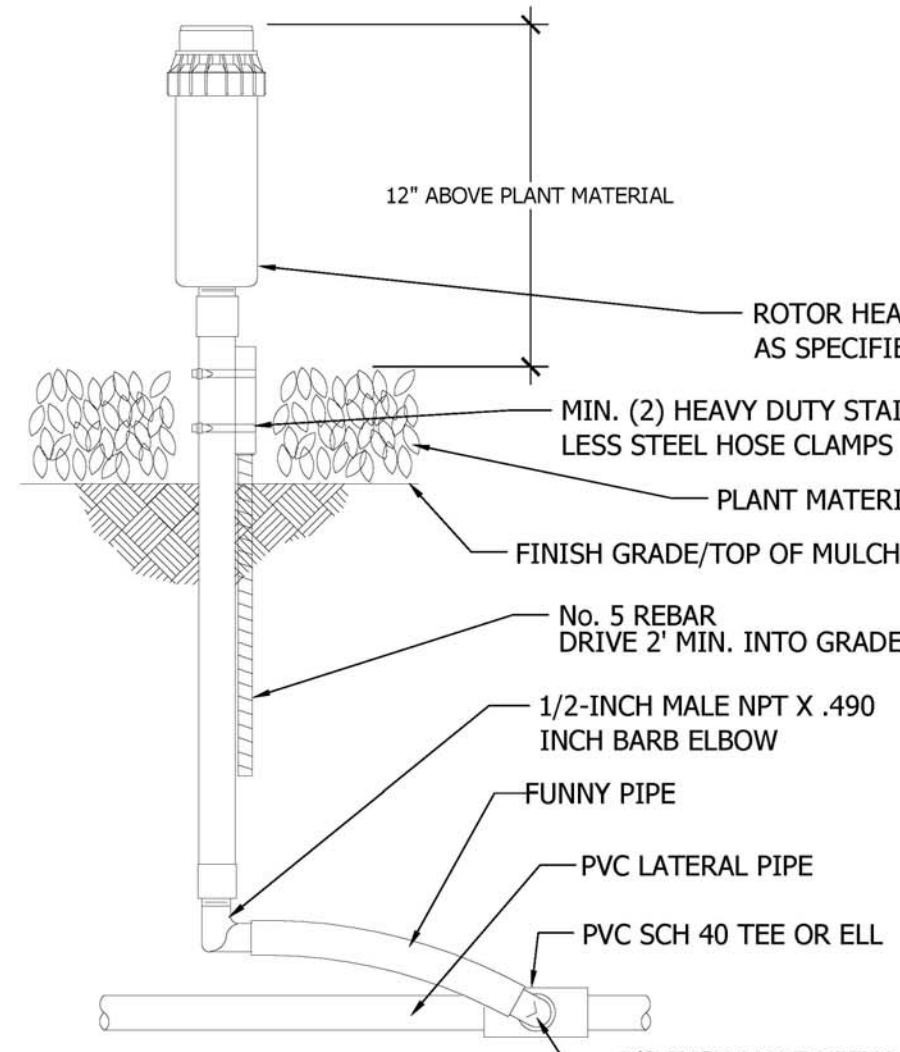

ROTOR RISER DETAIL N.T.S.

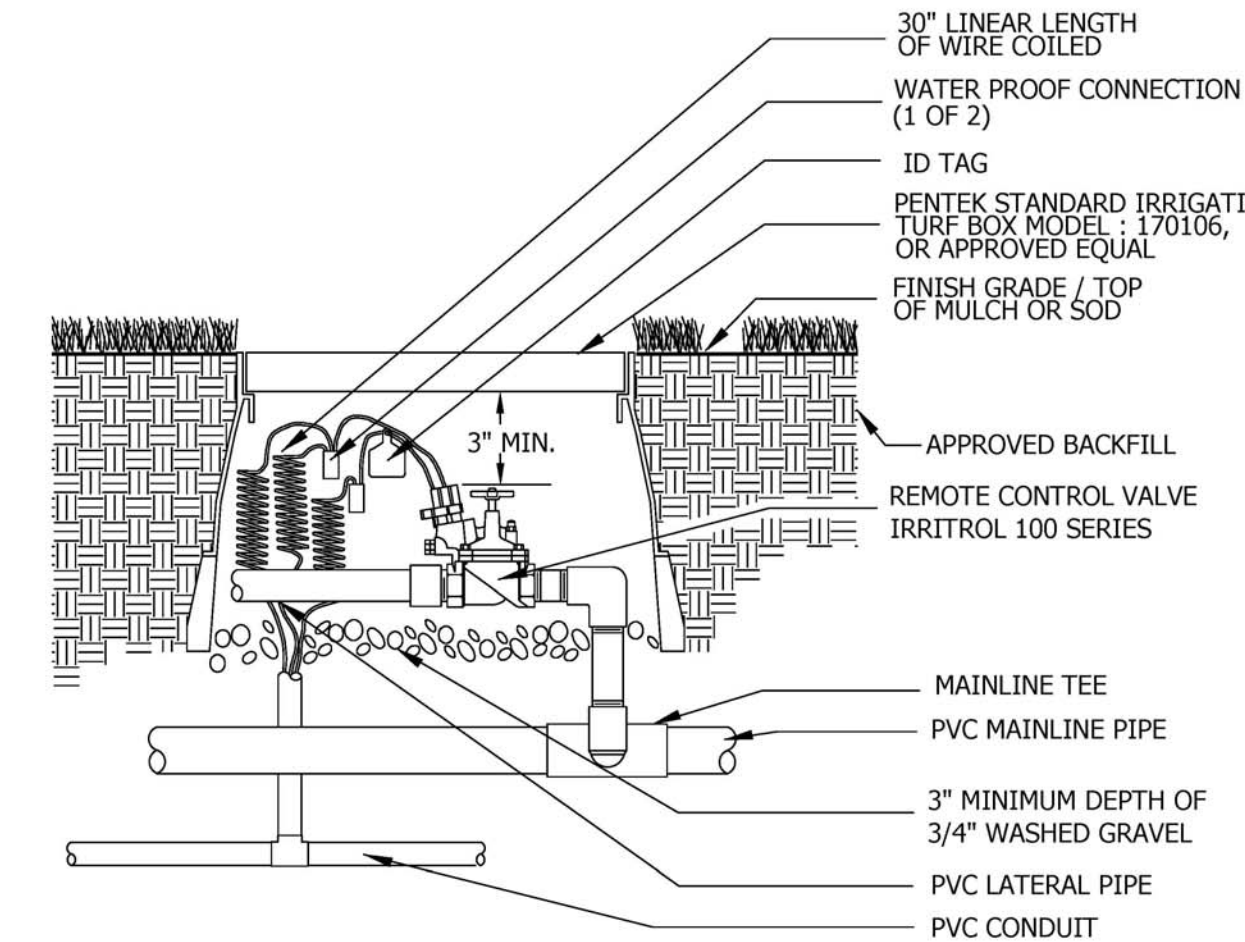

VALVE DETAIL N.T.S.

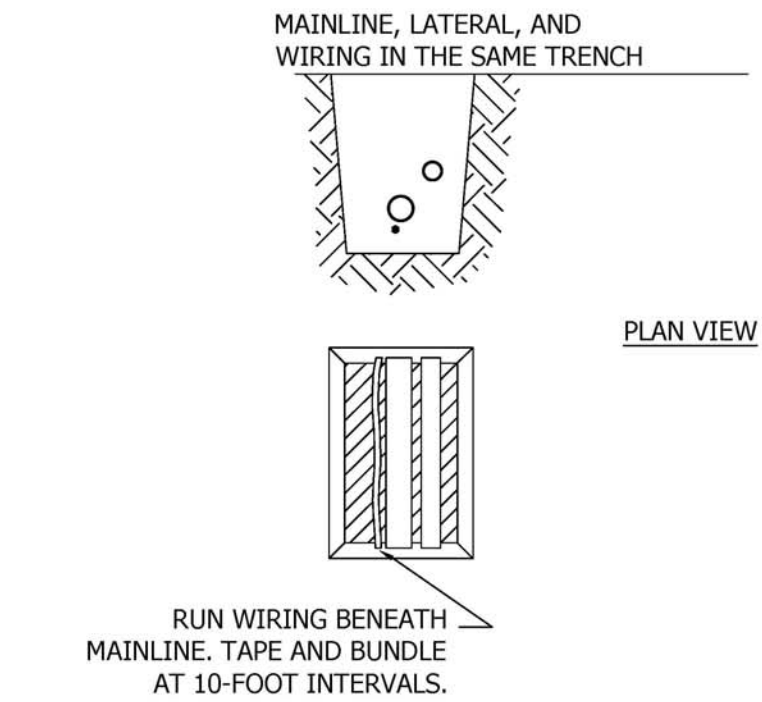

PIPE & TRENCHING DETAIL N.T.S.

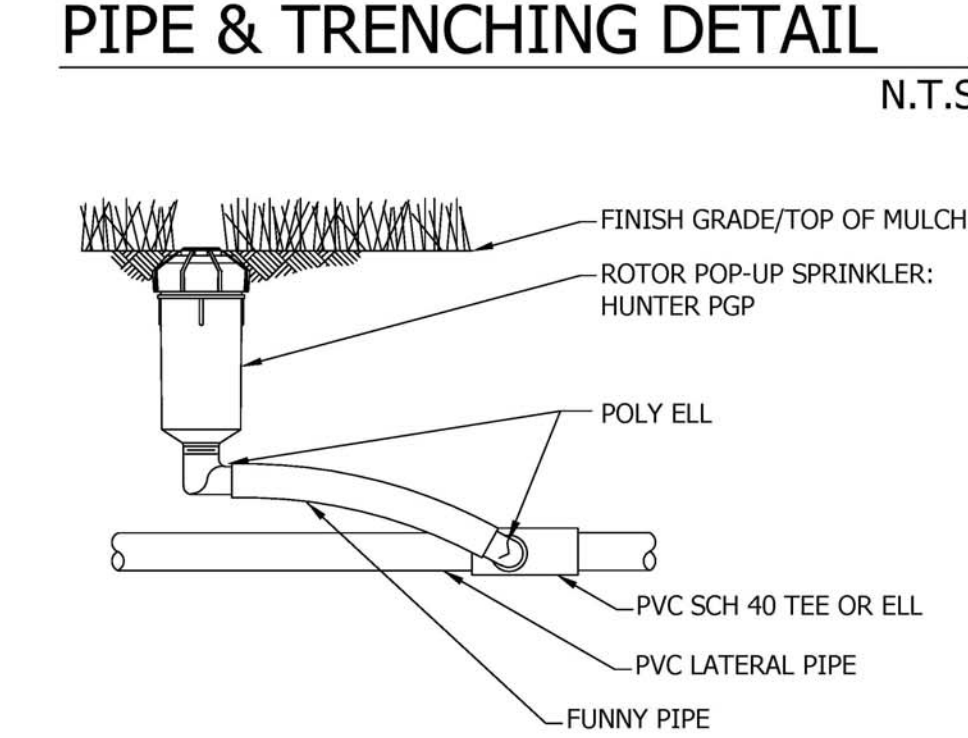

HUNTER PGP ROTOR DETAIL N.T.S.

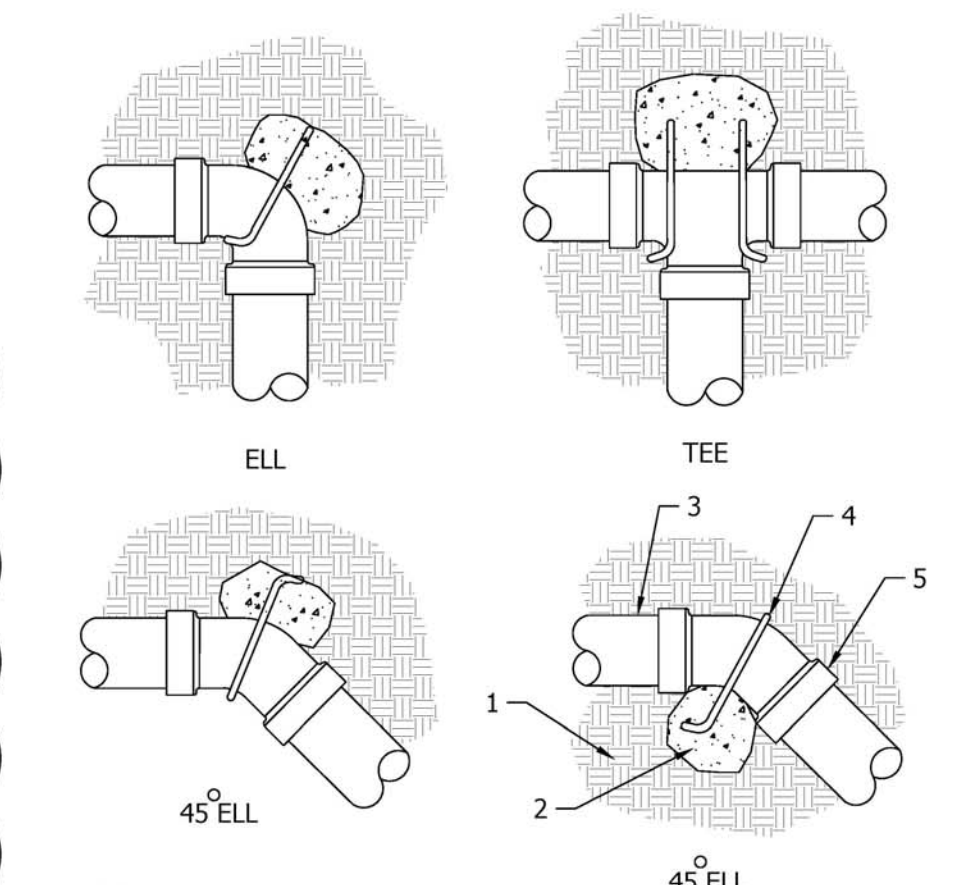

THRUST BLOCK DETAIL N.T.S.

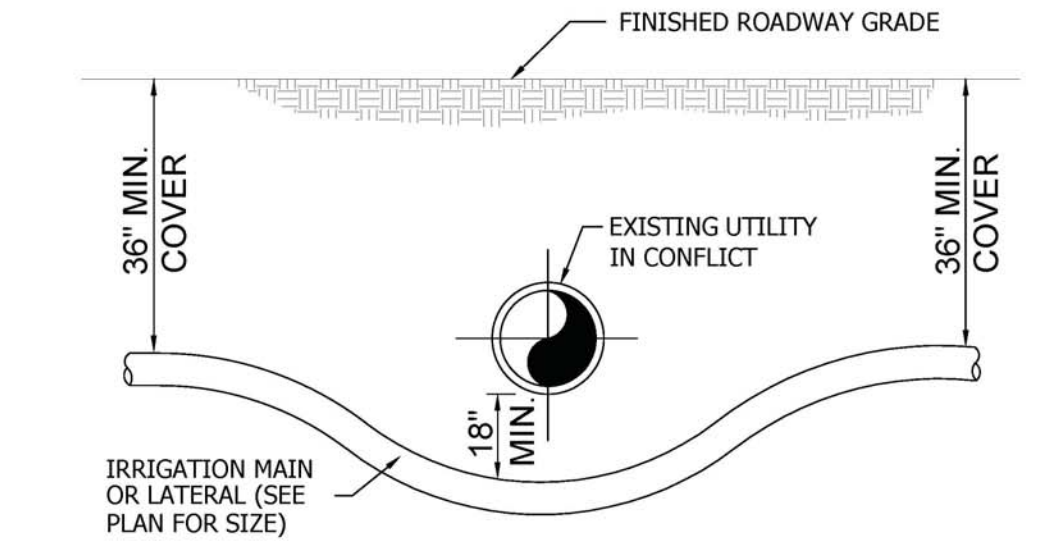

TYPICAL CONFLICT/DIRECTIONAL BORE DETAIL N.T.S.

REG
Architects
Interiors
Planners
CORP# AA0002447

Rick Gonzalez, AIA
President
FL License AR0014172
120 South Olive Ave. Ste. 210,
West Palm Beach, FL 33401
P (561) 659-2383
www.regarchitects.com



Village Hall of Royal Palm Beach

1050 Royal Palm Beach Blvd.
Royal Palm Beach, FL 33411

Coteleur & Hearing

NO.	DATE	DESCRIPTION
1	5/28/21	100% CD's.
	6/17/21	ADDENDA #1

DATE	05-28-2021
DESIGNER	REG/CH
DRAWN	BC/BF/RL/EB
CHECKED	MHA/REG
CH #	20-0206
© REG 2020	

OWNERSHIP AND USE OF THESE DOCUMENTS & SPECIFICATIONS AS INSTRUMENTS OF SERVICE ARE AND SHALL REMAIN THE PROPERTY OF THE ARCHITECT WHETHER THE PROJECT THEY ARE MADE FOR IS EXECUTED OR NOT. THEY SHALL NOT BE USED BY THE OWNER OR OTHERS ON OTHER PROJECTS OR FOR ADDITIONS TO THIS PROJECT BY OTHERS, EXCEPT BY AGREEMENT IN WRITING AND WITH APPROPRIATE COMPENSATION TO THE ARCHITECT.

Irrigation Details

ID-5

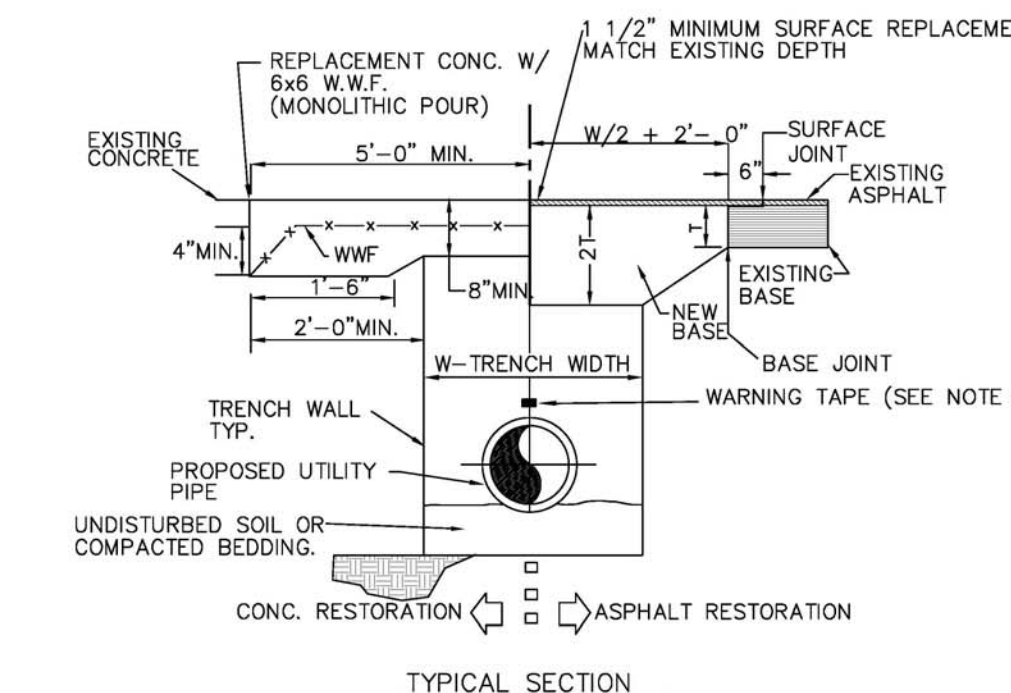

1

- NOTES:**
- SURFACE AND BASE CUTS SHALL BE SAW-CUT.
 - LONGITUDINAL OR DIAGONAL CUTS REQUIRE OVERLAY/RESURFACING COMPLETE WIDTH OF ROAD.
 - CUTS AT INTERSECTIONS REQUIRE COMPLETE OVERLAY/RESURFACING TO END OF ALL RETURN RADS AND/OR 10' FT. BEYOND CUT, WHICH EVER IS GREATER.
 - CUTS THROUGH TURNOUTS AND CUL-DE-SACS REQUIRE COMPLETE OVERLAY/RESURFACING.
 - COMPACTION OF FINAL BACKFILL SHALL BE 98% OF AASHTO T-180; COMPACTION AROUND PIPE SHALL BE 95%, EXCEPT AS OTHERWISE REQUIRED BY PERMITTING AUTHORITY.
 - PLACE PRINTED WARNING TAPE 12"-18" ABOVE PIPE.

OPEN CUT DETAIL N.T.S.

ELECTRIC SERVICE NOTES

- CONTRACTOR SHALL BE RESPONSIBLE FOR INSTALLING NEW CONDUIT AND WIRE FROM THE EXISTING ELECTRIC SERVICE TO THE PROPOSED IRRIGATION PUMP STATION AND FOR ALL DESIGN, MATERIALS, AND LABOR REQUIRED FOR A FULLY FUNCTIONAL PUMP STATION. ALL ELECTRICAL WORK SHALL BE IN ACCORDANCE WITH THE MOST RECENT VERSION OF THE NEC.

Irrigation Details