

Rick Gonzalez, AIA
President
FL License AR0014172
120 South Olive Ave. Ste. 210,
West Palm Beach, FL 33401
P (561) 659-2383
www.regarchitects.com



Village Hall of
Royal Palm Beach

1050 Royal Palm Beach Blvd.
Royal Palm Beach, FL 33411



NO.	DATE	DESCRIPTION
	5/28/21	100% CONST.
1	6/17/21	ADDENDA #1

DATE	05-28-2021
DESIGNER	REG/CH
DRAWN	BC/BF/RL/EB
CHECKED	MHA/REG
CH #	20-0206
© REG	2020

OWNERSHIP AND USE OF THESE DOCUMENTS AND SPECIFICATIONS AS INSTRUMENTS OF SERVICE ARE AND SHALL REMAIN THE PROPERTY OF THE ARCHITECT WHETHER THE PROJECT THEY ARE MADE FOR IS EXECUTED OR NOT. THEY SHALL NOT BE USED BY THE OWNER OR OTHERS ON OTHER PROJECTS OR FOR ADDITIONS TO THIS PROJECT BY OTHERS, EXCEPT BY AGREEMENT IN WRITING AND WITH APPROPRIATE COMPENSATION TO THE ARCHITECT.

Hardscape Plan

HP-7

1

SIGNAGE LOCATION MAP

MONUMENT SIGNAGE AND WAYFINDING SIGNAGE IS APPROXIMATE. FINAL LOCATIONS TO BE FIELD LOCATED WITH LANDSCAPE ARCHITECT, THE VILLAGE, AND CONTRACTOR.

LEGEND

- M-#** MONUMENT SIGN
- D-#** EXISTING DIRECTIONAL SIGN TO BE REPLACED
- N-#** NEW DIRECTIONAL SIGN

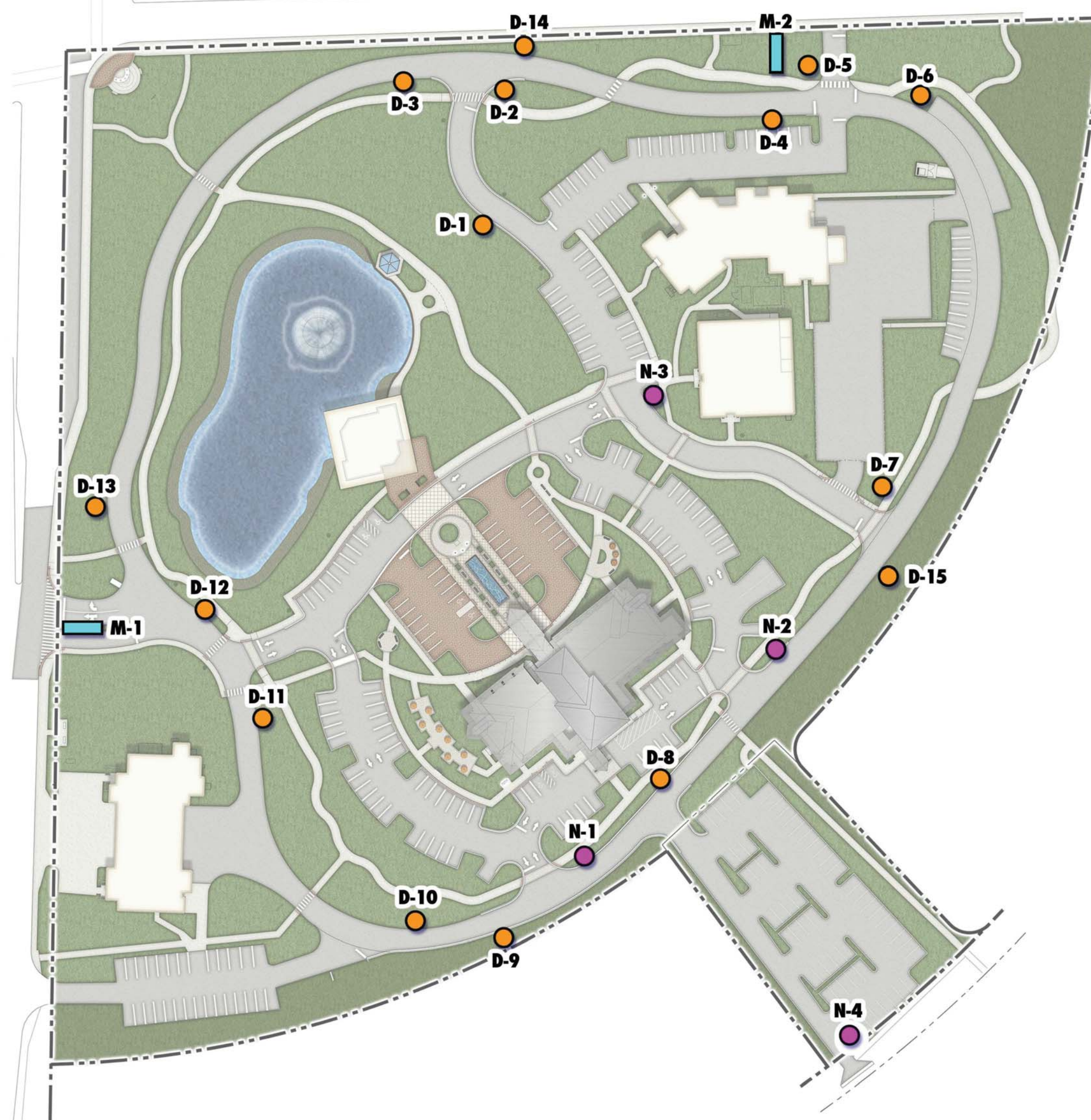

SIGN LOCATION	SIGN FACE DIRECTORY
D-1 NORTH FACE	→ PBSO DISTRICT 9 → DAVID B. FARBER TRAINING CENTER ↑ VILLAGE HALL ↑ POST OFFICE
D-2 SOUTH FACE	→ PBSO DISTRICT 9 → OKEECHOBEE BLVD. → ROYAL PALM BEACH BLVD. → PBSO DISTRICT 9
D-3 WEST FACE	→ DAVID B. FARBER TRAINING CENTER → VILLAGE HALL ↑ OKEECHOBEE BLVD. → PBSO DISTRICT 9
D-4 WEST FACE	→ OKEECHOBEE BLVD. ↑ PBSO DISTRICT 9 → VILLAGE HALL → POST OFFICE
D-5 NORTH FACE	→ DAVID B. FARBER TRAINING CENTER → OKEECHOBEE BLVD. → PBSO DISTRICT 9 ↑ VILLAGE HALL
D-6 EAST FACE	→ PBSO DISTRICT 9 ↑ VILLAGE HALL ↑ VILLAGE HALL ↑ POST OFFICE
D-7 NORTH FACE	↑ POST OFFICE → PBSO DISTRICT 9 → DAVID B. FARBER TRAINING CENTER → VILLAGE HALL
D-8 SOUTH FACE	→ POST OFFICE → PBSO DISTRICT 9 → DAVID B. FARBER TRAINING CENTER → VILLAGE HALL
D-9 WEST FACE	→ POST OFFICE ↑ PBSO DISTRICT 9 → SPARROW DRIVE → VILLAGE HALL
D-10 WEST FACE	→ POST OFFICE → PBSO DISTRICT 9 → VILLAGE HALL → POST OFFICE
D-11 SOUTH FACE	→ ROYAL PALM BEACH BLVD. ↑ PBSO DISTRICT 9 → VILLAGE HALL → POST OFFICE
D-12 WEST FACE	→ DAVID B. FARBER TRAINING CENTER → PBSO DISTRICT 9 → ROYAL PALM BEACH BLVD. ↑ VILLAGE HALL ↑ POST OFFICE
D-13 NORTH FACE	↑ VILLAGE HALL ↑ POST OFFICE ↑ DAVID B. FARBER TRAINING CENTER → PBSO DISTRICT 9
D-14 EAST FACE	→ DAVID B. FARBER TRAINING CENTER → VILLAGE HALL → POST OFFICE → PBSO DISTRICT 9
D-15 SOUTH FACE	→ DAVID B. FARBER TRAINING CENTER ↑ OKEECHOBEE BLVD. → VILLAGE HALL → POST OFFICE
N-1 EAST FACE	↑ POST OFFICE ↑ ROYAL PALM BEACH BLVD. → VILLAGE HALL
N-2 EAST FACE	→ VILLAGE HALL → POST OFFICE → SPARROW DRIVE → VILLAGE HALL
N-3 SOUTH FACE	→ DAVID B. FARBER TRAINING CENTER ↑ PBSO DISTRICT 9 ↑ OKEECHOBEE BLVD. → VILLAGE HALL → POST OFFICE
N-4 EAST FACE	→ PBSO DISTRICT 9 → DAVID B. FARBER TRAINING CENTER → VILLAGE HALL → POST OFFICE
N-4 WEST FACE	→ PBSO DISTRICT 10 → DAVID B. FARBER TRAINING CENTER

MONUMENT AND WAYFINDING SIGN BASIS OF DESIGN:
SIGNARAMA WILL DESIGN, ENGINEER, FABRICATE AND INSTALL SIGNAGE STRUCTURE AND FINISH TO MATCH AESTHETIC INTENT SPECIFIED ON THESE DRAWINGS INCLUDING SUPPORT STRUCTURE AND FOUNDATION. STONE FINISH IN SIGNAGE WILL BE THE SAME PRECAST STONE VENEER USED IN PROPOSED BUILDING. CONTRACTOR TO PROVIDE STONE VENEER IN QUANTITY NEEDED. SIGN MANUFACTURER WILL COORDINATE INSTALLATION OF STONE TO SIGN SURFACE. SIGN MANUFACTURER WILL PROVIDE COMPLETE SIGN SYSTEM SHOP DRAWINGS AND FINISHES FOR REVIEW PRIOR TO SIGN FABRICATION.
*REFER TO ARCHITECTURAL DRAWINGS FOR ADDITIONAL INFORMATION ON SIGNAGE.
SIGNARAMA
2905 S. CONGRESS AVE.
DELRAY BEACH, FL 33445
(561) 278-7446
CONTACT: CHRIS LEVEY

Wayfinding Signage

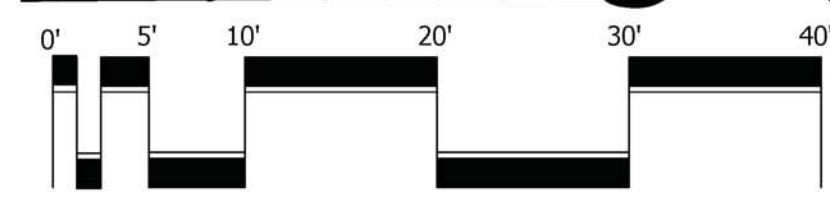

Scale: 1" = 10'-0"



North

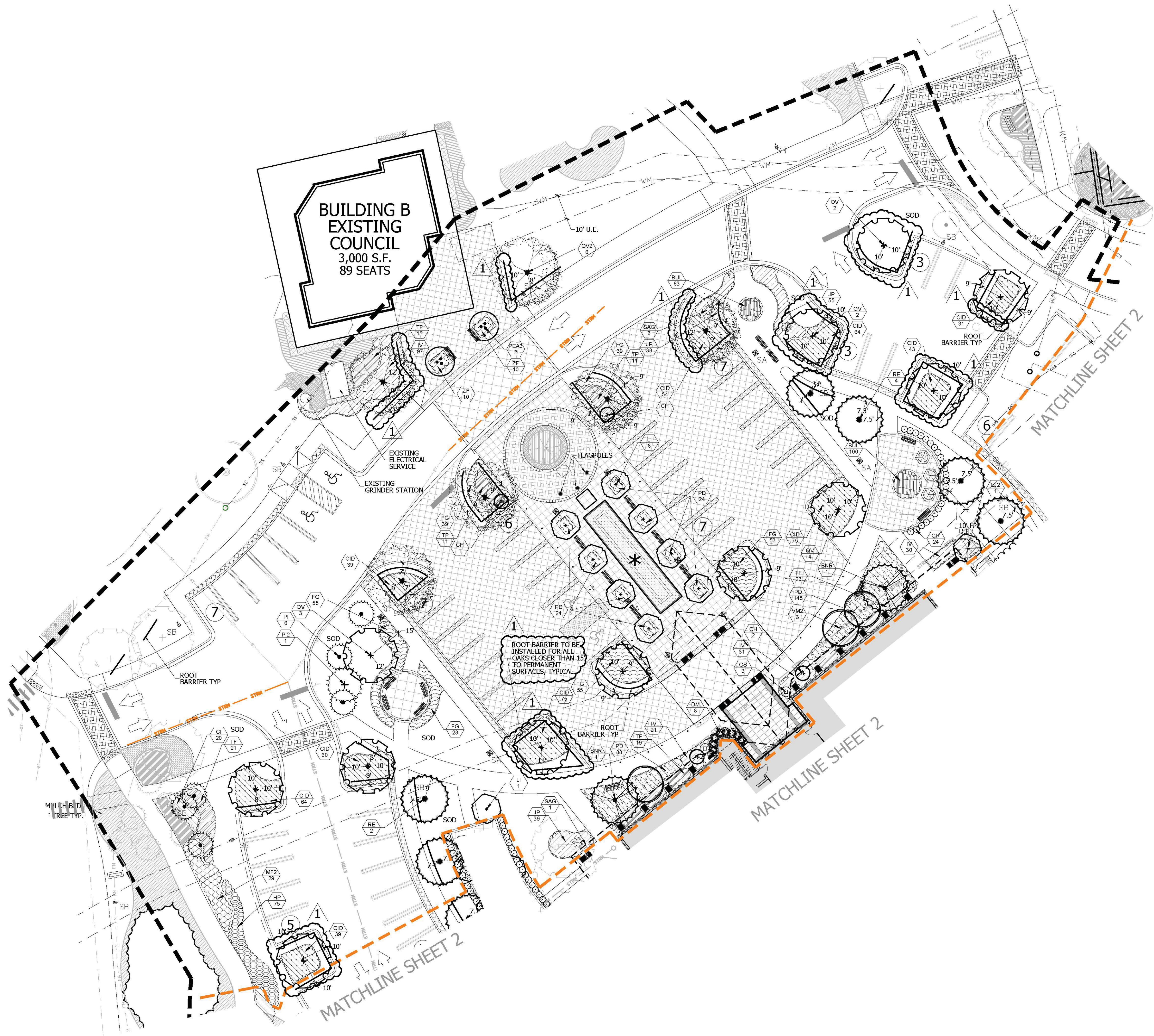

KEY MAP

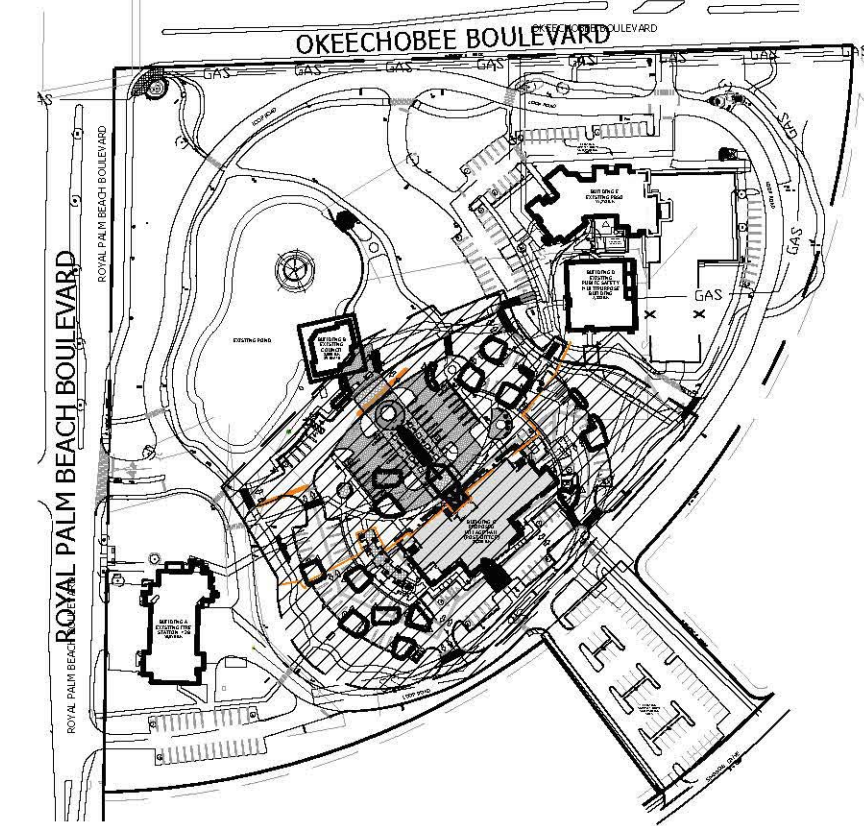

EX. TREE LEGEND

- (RE) ROYAL PALMS
- OTHER PALMS
- (PE) PINES
- (TD) CYPRESS
- (SP) SABAL PALMS
- (BB/TA) BLACK OLIVES/TABEUBIA
- OTHER CANOPY TREES
- (SER) SAW PALMETTO

REG

Architects
Interiors
Planners

CORP# AA0002447



Est. 1988

Rick Gonzalez, AIA
President

FL License AR0014172
120 South Olive Ave. Ste. 210,
West Palm Beach, FL 33401
P (561) 659-2383
www.regarchitects.com



Village Hall of
Royal Palm Beach

1050 Royal Palm Beach Blvd.
Royal Palm Beach, FL 33411



NO.	DATE	DESCRIPTION
1	5/28/21	100% CONST.
	6/17/21	ADDENDA#1

DATE	05-28-2021
DESIGNER	REG/CH
DRAWN	BC/BF/R/UEB
CHECKED	MHA/REG
CH#	20-0206

© REG 2020

OWNERSHIP AND USE OF THESE DOCUMENTS & SPECIFICATIONS AS INSTRUMENTS OF SERVICE ARE AND SHALL REMAIN THE PROPERTY OF THE ARCHITECT WHETHER THE PROJECT THEY ARE MADE FOR IS EXECUTED OR NOT. THEY SHALL NOT BE USED BY THE OWNER OR OTHERS ON OTHER PROJECTS OR FOR ADDITIONS TO THIS PROJECT BY OTHERS, EXCEPT BY AGREEMENT IN WRITING AND WITH APPROPRIATE COMPENSATION TO THE ARCHITECT.

Landscape
Plan

LP-1

SAMPLE PROJECT SIGNAGE





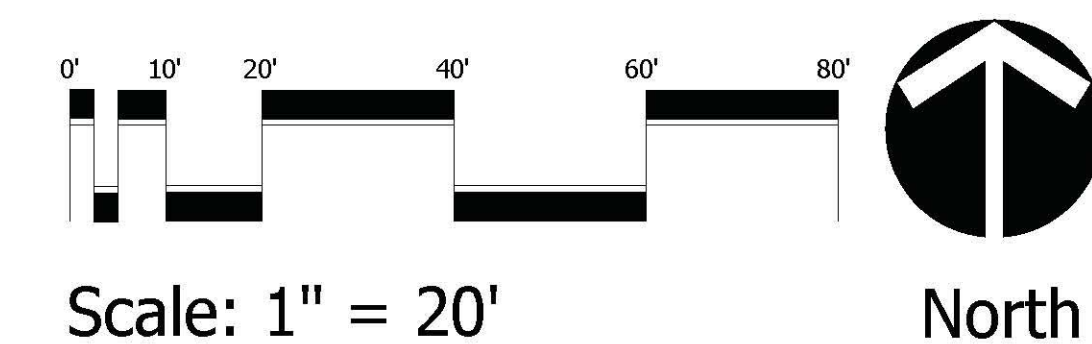





Landscape Plan
Phase II

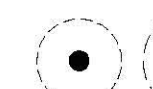

Scale: 1" = 20'

North

EX. TREE LEGEND

-  (RE) ROYAL PALMS
-  OTHER PALMS
-  (PE) PINES
-  (TD) CYPRESS
-  (SP) SABAL PALMS
-  (BB/TA) BLACK OLIVES/TABEBUIA
-  OTHER CANOPY TREES
-  (SER) SAW PALMETTO

KEY MAP

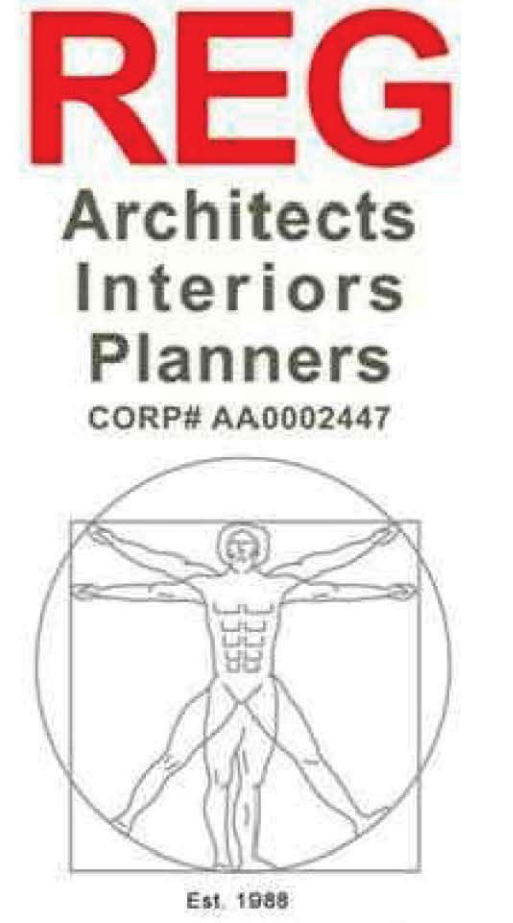
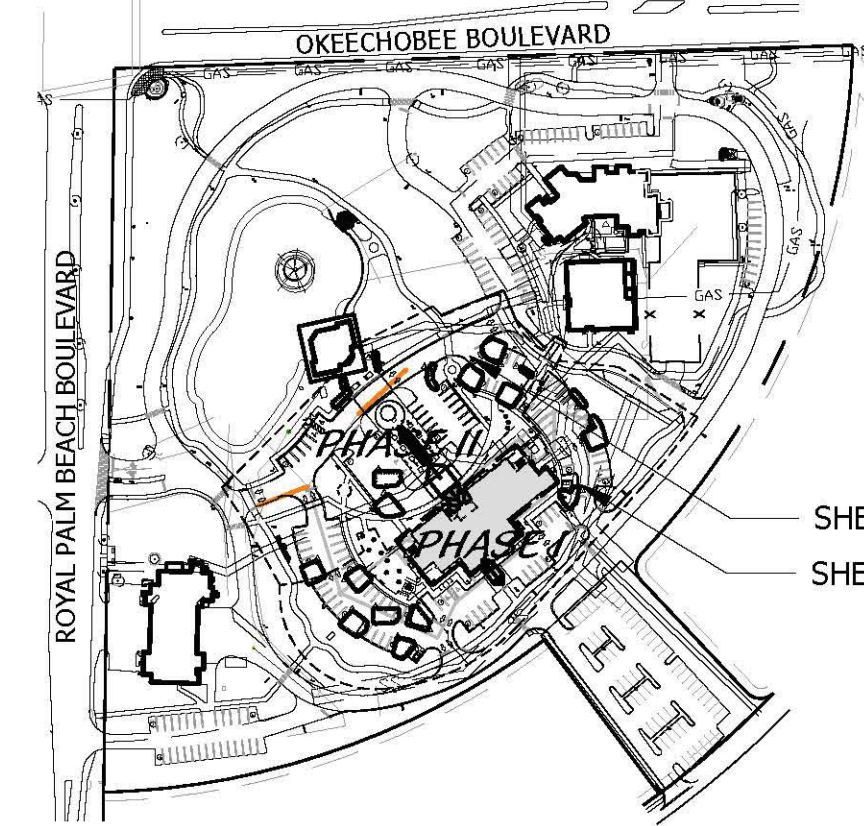

REG
Architects
Interiors
Planners
CORP# AA0002447

Rick Gonzalez, AIA
President
FL License AR0014172
120 South Olive Ave. Ste. 210,
West Palm Beach, FL 33401
P (561) 659-2383
www.regarchitects.com



**Village Hall of
Royal Palm Beach**

1050 Royal Palm Beach Blvd.
Royal Palm Beach, FL 33411



NO.	DATE	DESCRIPTION
1	4/26/21	100% CONST.
	6/17/21	ADDENDA #1

DATE	04-26-2021
DESIGNER	REG/CH
DRAWN	BC/BF/RJEB
CHECKED	MHA/REG
CH #	20-0206

© REG 2020

OWNERSHIP AND USE OF THESE DOCUMENTS & SPECIFICATIONS AS INSTRUMENTS OF SERVICE ARE AND SHALL REMAIN THE PROPERTY OF THE ARCHITECT WHETHER THE PROJECT THEY ARE MADE FOR IS EXECUTED OR NOT. THEY SHALL NOT BE USED BY THE OWNER OR OTHERS ON OTHER PROJECTS OR FOR ADDITIONS TO THIS PROJECT BY OTHERS, EXCEPT BY AGREEMENT IN WRITING AND WITH APPROPRIATE COMPENSATION TO THE ARCHITECT.

Landscape
Plan

LP-2



TRANSFORMER DETAIL

ELEVATION VIEW NTS

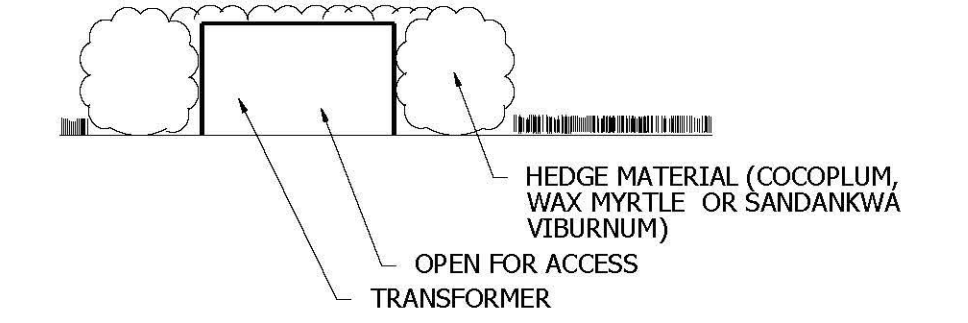

PLAN VIEW

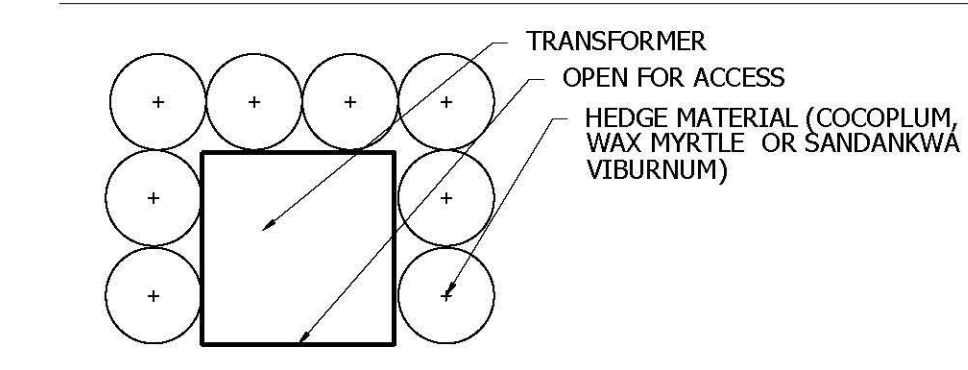

**Landscape Plan
Phase I**

